



SUPER CONTRA™

INSTRUCTION MANUAL

SUPER CONTRA™ is a registered trademark of Konami Inc. © 1988 Konami Inc.

 KONAMI® is a trademark of Konami Industry Co., Ltd.

TABLE OF CONTENTS

	Page		Page
Wiring Harness	1	Dip Switch Settings	4
AC Flow Chart	2	Coin Door Assembly	5-8
Wiring Diagram	3		

SUPER CONTRA: WIRING HARNESS

Solder Side ← → Parts Side

WIRE COLOR KEY:

BLACK	GND	A	1	GND	BLACK
BLACK	GND	B	2	GND	BLACK
RED	+5V DC	C	3	+5V DC	RED
RED	+5V DC	D	4	+5V DC	RED
	NOT USED	E	5	NOT USED	
ORANGE	+12V DC	F	6	+12V DC	ORANGE
	*KEY	H	7	*KEY	
BROWN/YELLOW	COIN COUNTER 2	J	8	COIN COUNTER 1	GREEN/GRAY
	(EMPTY)	K	9	(EMPTY)	
	SPEAKER (-)	L	10	SPEAKER (+)	
	(EMPTY)	M	11	(EMPTY)	
WHITE/GREEN	VIDEO GREEN	N	12	VIDEO RED	RED/WHITE
WHITE	VIDEO SYNC	P	13	VIDEO BLUE	BLUE/WHITE
RED/YELLOW	SERVICE SW	R	14	VIDEO GROUND	BLACK
	(EMPTY)	S	15	(EMPTY)	
VIOLET/WHITE	COIN 2	T	16	COIN 1	BLUE/BROWN
RED/GREEN	2P START	U	17	1P START	PINK/YELLOW
BLUE/YELLOW	2P UP	V	18	1P UP	ORANGE/WHITE
VIOLET/YELLOW	2P DOWN	W	19	1P DOWN	BLACK/WHITE
ORANGE/GREEN	2P LEFT	X	20	1P LEFT	RED/GRAY
ORANGE/YELLOW	2P RIGHT	Y	21	1P RIGHT	GRAY/WHITE
BLACK/YELLOW	2P SHOOT	Z	22	1P SHOOT	PINK/WHITE
ORANGE/GRAY	2P JUMP	a	23	1P JUMP	GREEN/BROWN
	NOT USED	b	24	NOT USED	
	NOT USED	c	25	NOT USED	
	NOT USED	d	26	NOT USED	
BLACK	GND	e	27	GND	BLACK
BLACK	GND	f	28	GND	BLACK

(BASE COLOR/LINE COLOR)

SUPER CONTRA: AC FLOW CHART

1. GREEN/YELLOW
2. BLACK
3. RED
4. BLUE
5. BROWN
6. RED/BLACK
7. BLACK/WHITE
8. WHITE
9. GREEN
10. VIOLET
11. ORANGE

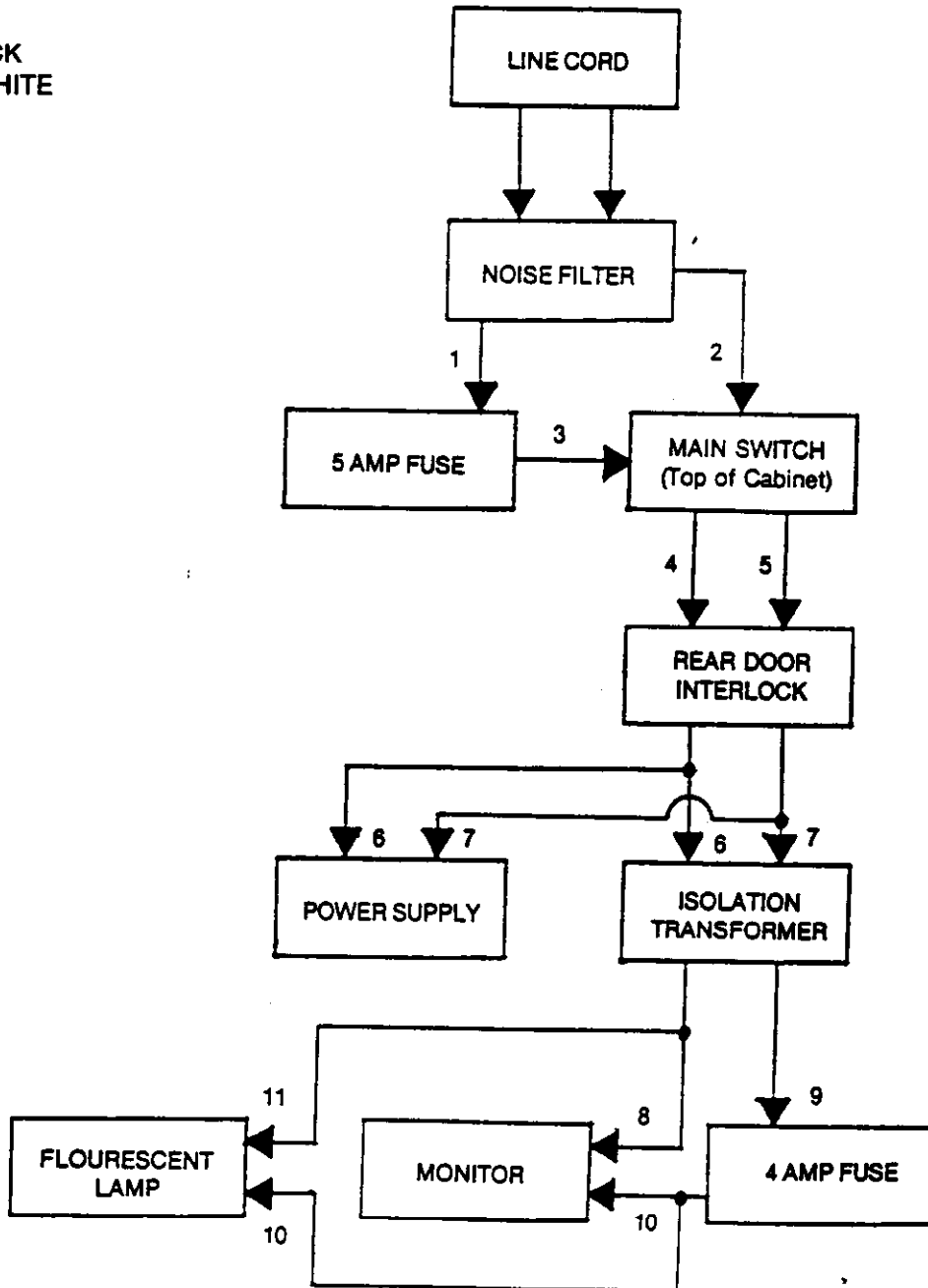

SUPER CONTRA: WIRING DIAGRAM

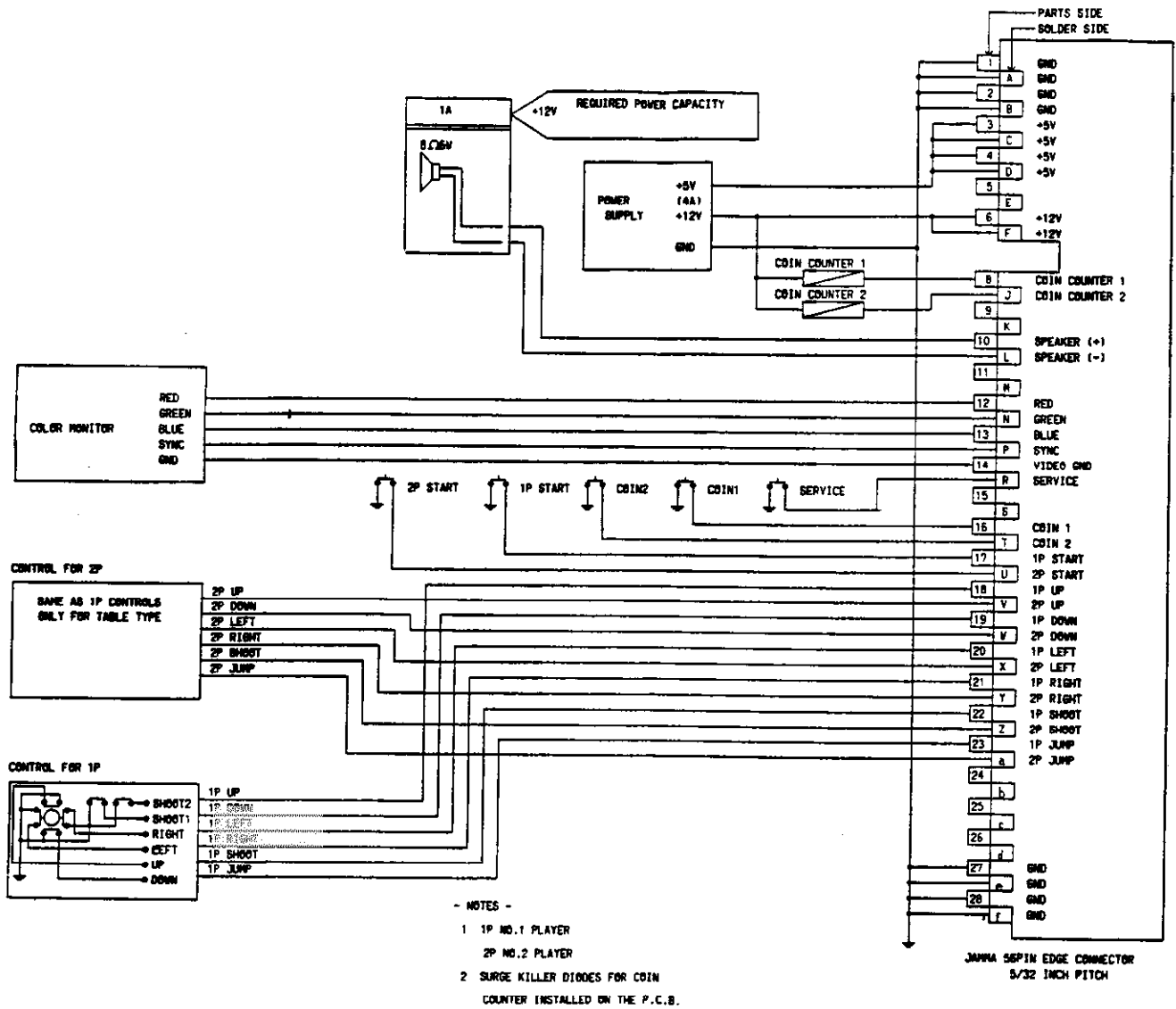

DIP SWITCH SETTINGS

DIP SWITCH NO. 1 SETTINGS

1. COIN 1

SW	1	2	3	4	COIN	PLAY
•	OFF	OFF	OFF	OFF	1	1
	ON	OFF			1	2
	OFF	ON			1	3
	ON	ON			1	4
	OFF	OFF	ON	OFF	1	5
	ON	OFF			1	6
	OFF	ON			1	7
	ON	ON			2	1
	OFF	OFF	OFF	ON	2	3
	ON	OFF			2	5
	OFF	ON			3	1
	ON	ON			3	2
	OFF	OFF	ON	ON	3	4
	ON	OFF			4	1
	OFF	ON			4	3
	ON	ON			FREEPLAY	

FREEPLAY: You can play game without coins.

DIP SWITCH NO. 2 SETTINGS

1. THE NUMBER OF PLAYER'S LIFE

SW	1	2	NUMBER
•	OFF	OFF	2
	ON	OFF	3
	OFF	ON	5
	ON	ON	7

2. CHANGE OF TABLE/UPRIGHT

SW	3	TYPE
•	OFF	TABLE
	ON	UPRIGHT

3. BONUS LIFE

SW	4	5	BONUS LIFE
•	OFF	OFF	At 30,000 pts. and 200,000 pts.
	ON		At 50,000 pts. and 300,000 pts.
	OFF	ON	At 30,000 pts. only
	ON	ON	At 50,000 pts. only

4. DIFFICULTY OF THE GAME

SW	6	7	DIFFICULTY
•	OFF	OFF	EASY
	ON	OFF	NORMAL
	OFF	ON	DIFFICULT
	ON	ON	VERY DIFFICULT

2. COIN 2

SW	5	6	7	8	COIN	PLAY
•	OFF	OFF	OFF	OFF	1	1
	ON	OFF			1	2
	OFF	ON			1	3
	ON	ON			1	4
	OFF	OFF	ON	OFF	1	5
	ON	OFF			1	6
	OFF	ON			1	7
	ON	ON			2	1
	OFF	OFF	OFF	ON	2	3
	ON	OFF			2	5
	OFF	ON			3	1
	ON	ON			3	2
	OFF	OFF	ON	ON	3	4
	ON	OFF			4	1
	OFF	ON			4	3
	ON	ON			VOID	

5. SOUND IN ATTRACTIVE MODE

SW	8	SOUND
•	OFF	OFF
	ON	ON

DIP SWITCH NO.3 SETTINGS

1. VIDEO SCREEN FLIP

SW	1	VIDEO SCREEN (Monitor)
•	OFF	NORMAL
	ON	UPSIDE DOWN

2. CHANGE OF MODE

SW	3	MODE
•	OFF	GAME MODE
	ON	CHECK MODE

3. CONTINUATION

SW	4	1 PLAYER PLAY	2 PLAYER PLAY
•	OFF	Up to 3 times	Up to twice altogether
	ON	Up to 5 times	Up to 4 times altogether

SW2 is not used.

- Shows recommended settings

COMPLETE COIN DOOR ASSEMBLY EXPLODED VIEW

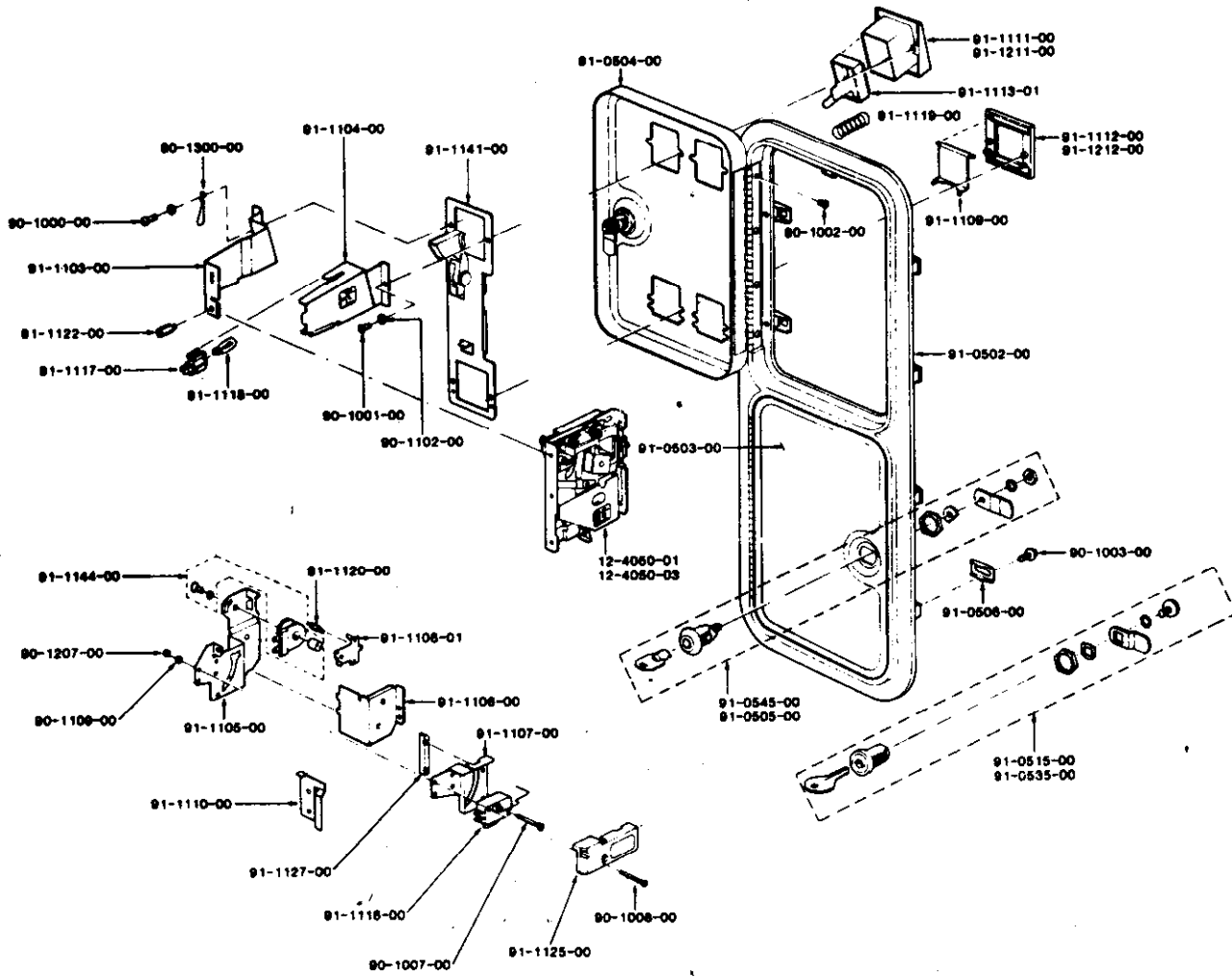

PARTS LIST

12-4050-01	S-10 Acceptor Body U.S. 25*	90-1102-00	Washer for Bezel Screw	91-1103-00	Coin Inlet Lamp Side	91-1119-00	Button Spring
12-4050-03	S-10 Acceptor Body Canadian 25*	90-1207-00	Nut for Microswitch Mounting Screw	91-1104-00	Coin Inlet Cover Side	91-1120-00	Lockout Spring
20-4177-00	Plastic Cash Box	90-1300-00	Keyhook	91-1105-00	Reject Cup Side Plate	91-1122-00	Retaining Screw for Acceptor Body
20-4179-00	Steel Enclosure	91-0502-00	Zinc Die Cast Frame	91-1106-00	Reject Cup Base Plate	91-1125-00	Clear Plastic Cover for Microswitch
22-1400-00	Locking Bar	91-0503-00	Lower Door	91-1107-00	Microswitch Bracket	91-1127-00	Plastic Switch Adjuster
24-1150-00	Wire Harness	91-0504-00	Upper Door	91-1108-01	Lockout Flap U.S. 25*	91-1141-00	Base Plate With Pivot and Stud
90-1000-00	Keyhook Bezel Screw	91-0505-00	Round Lock and Cam Assembly	91-1109-00	Reject Flap	91-1144-00	6 Volt DC Lockout Coil Assembly
90-1001-00	Bezel Screw	91-0506-00	Clamp	91-1110-00	Metal Switch Adjuster	91-1211-00	Zinc Plated Button Bezel
90-1002-00	Hinge Screw	91-0515-00	Flat Lock and Cam Assembly	91-1111-00	Black Button Bezel	91-1212-00	Zinc Plated Reject Bezel
90-1003-00	Clamp Screw	91-0535-00	Flat Lock and Cam Assembly	91-1112-00	Black Reject Bezel		
90-1007-00	Flat Head Microswitch Mounting Screw	91-0545-00	Round Lock and Cam Assembly	91-1113-01	Entry/Reject Button U.S. 25*		
90-1008-00	Panhead Microswitch Mounting Screw			91-1116-00	Microswitch (Black End Arm)		
				91-1117-00	Lampholder		
				91-1118-00	6 V Wedge Base Lamp		

Gold Mech

Engineering Data and Parts List

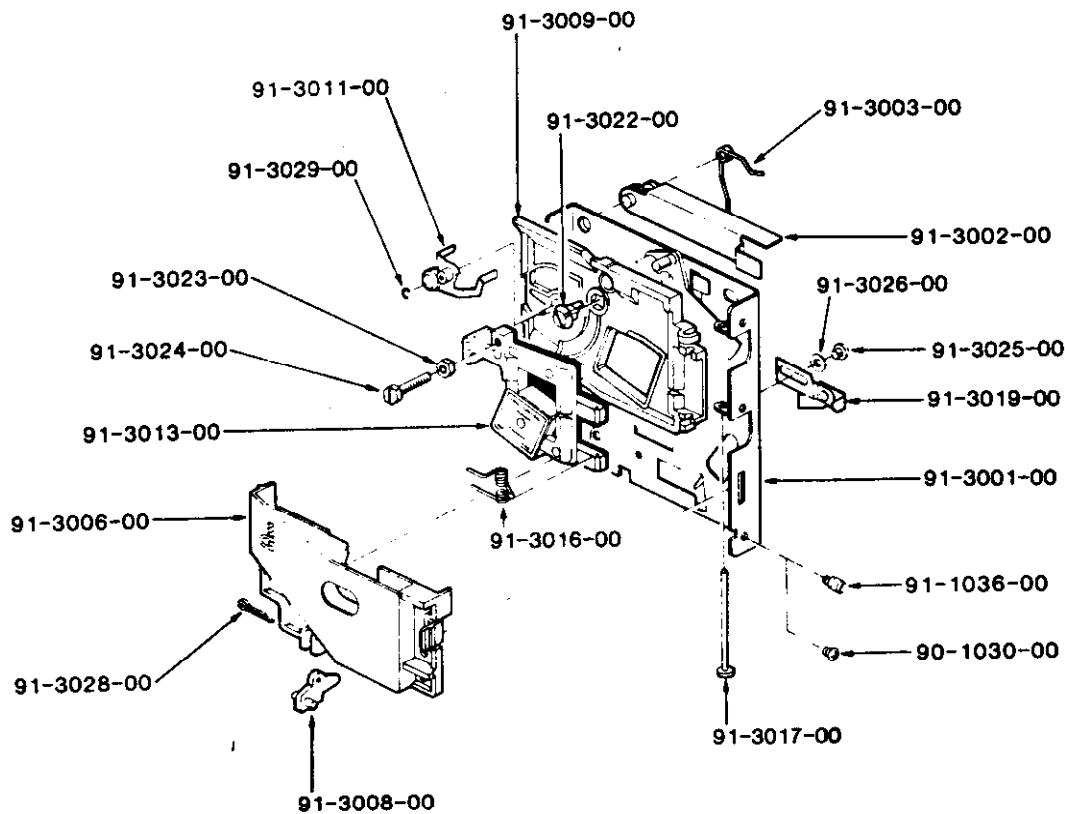

PARTS LIST

90-1030-00 Retaining Screw (#6-32"x.250")	91-3009-00 Gate	91-3023-00 Locknut-Magnet Holder
91-1036-00 Mounting Stud	91-3011-00 Cradle	91-3024-00 Screw-Magnet Holder
91-3001-00 Back Plate	91-3013-00 Magnet Holder with Magnet	91-3025-00 Screw Separator
91-3002-00 Reject Lever	91-3016-00 Gate Spring	91-3026-00 Washer
91-3003-00 Reject Lever Spring	91-3017-00 Gate Pin	91-3028-00 Cotter Pin for Anti-stringing Device
91-3006-00 Cover Plate	91-3019-00 Separator	91-3029-00 E-Clip for Cradle
91-3008-00 Anti-Stringing Device	91-3022-00 Diameter Adjustment	

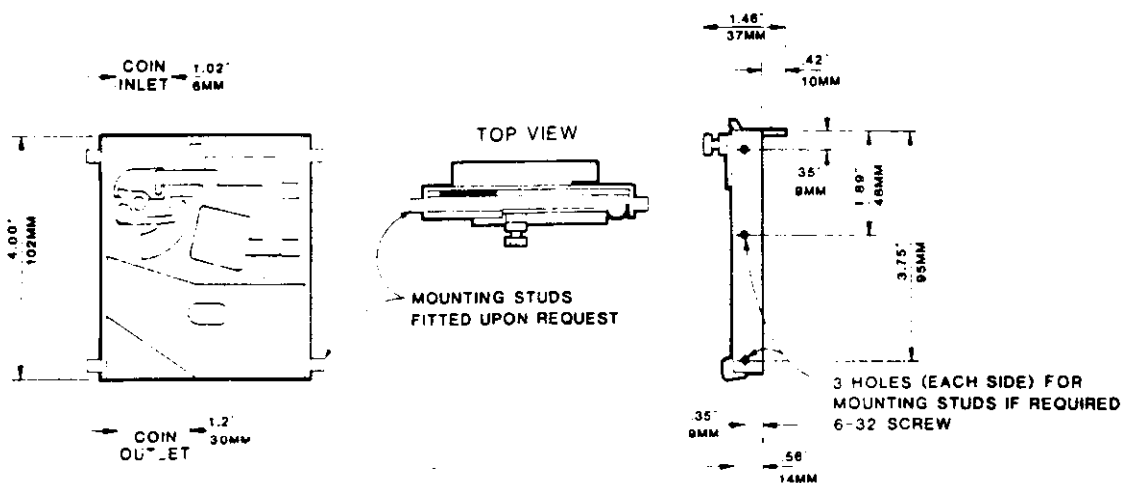

Gold Mech: Service Information

CLEANING and CARE of the MECHANISM

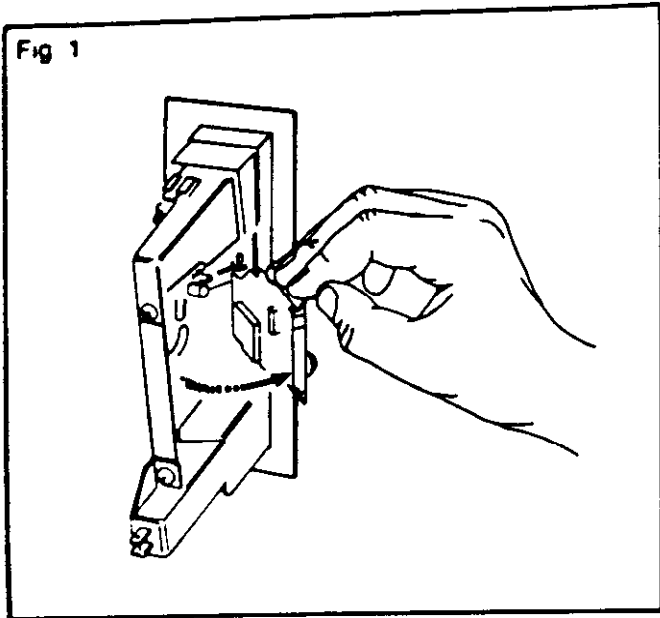

The magnet that is fitted to the mechanism, should be kept clean from foreign particles. The magnet can be cleaned by swinging the gate open, (as shown in Fig. 1.) Remove metal filings from the magnet by guiding the point of a screwdriver along the edges of the magnet, such that the filings cling to the screwdriver.

The mechanism can be cleaned by immersing in water using a small brush to clean the mechanism. Rinse the mechanism with boiling water and dry with compressed air.

Note:

Since the Gold Mech relies on coins passing the magnet at a constant speed, the rejector must be free of dirt and grease which may slow down the coins. Do not lubricate the acceptor with oil as this slows down coins.

If the above procedures are not successful, check for worn, bent or damaged parts and replace where necessary.

Coin Switch

The coin switch comes in two different spring tensions—identified by the color of the plastic boss at the wire's pivot point.

Red: Light tension—U.S. 25¢

White: Heavy tension—heavy foreign coins

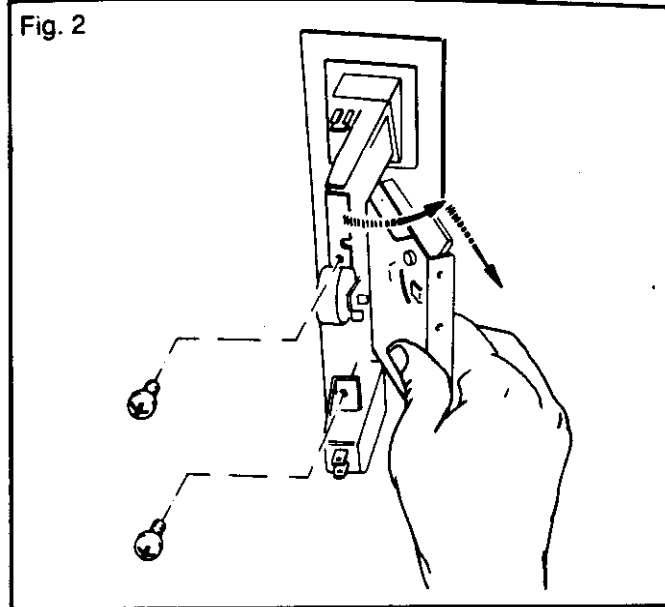

Removal of Mechanism

To remove the coin selector: Unscrew the two screws (as SHOWN IN Fig. 2)—swing rear of selector body away from the lock-out side and withdraw.

The Gold Mech Acceptors are designed to require a minimum of maintenance and field adjustment. Coins are checked by diameter and thickness, weight, metal content, bounce, and for ferromagnetic coins such as nickel and steel, a rim test is also used.

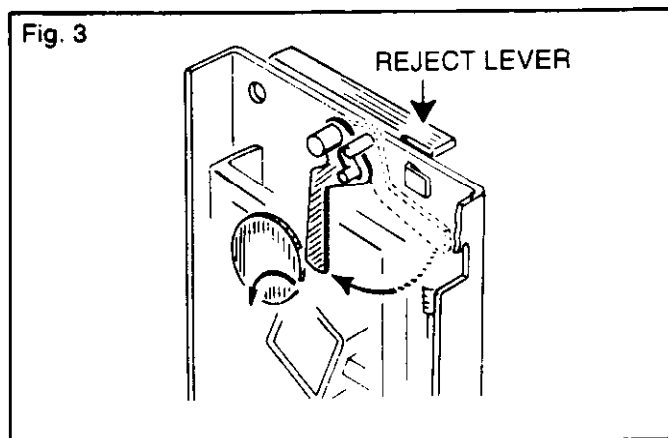

The Magnet

Coins that are too thick will fail to pass between the magnet and the backplate of the mechanism; and will be cleared by the magnet wiper when the reject lever is actuated. (Fig. 3)

Fig. 4

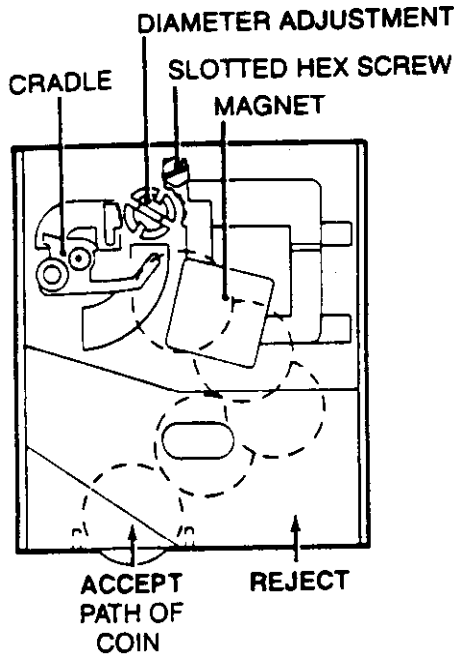

Base Plate Assembly for Coin Doors and Front Plates

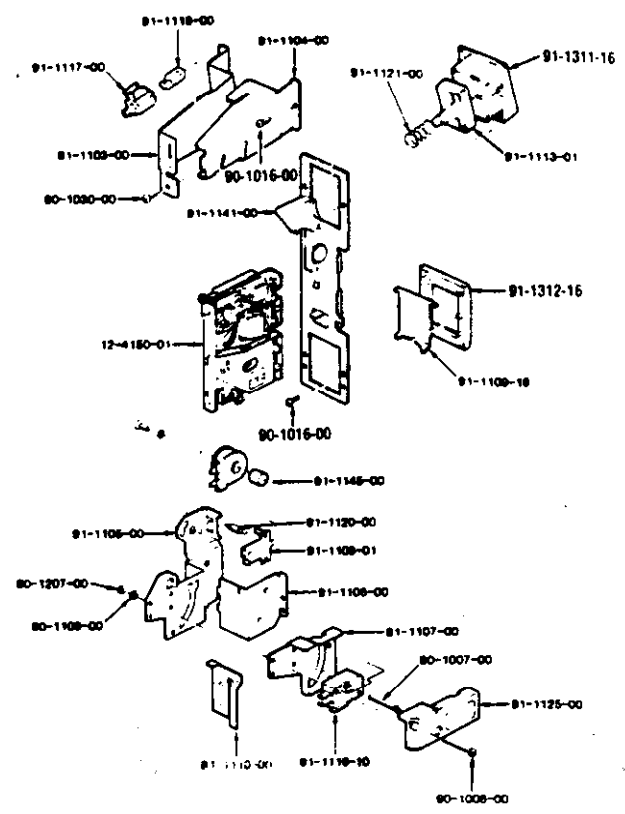

The first check on the coin is at the entry slot which prevents the entry of grossly oversize and bent coins. The next test is at the cradle. When the correct coin falls into the cradle, the cradle tips and the coin is delivered to the magnet check. Under-diameter coins fall between the legs of the cradle and are returned to reject. Under-weight coins fail to tip the cradle and can be returned to reject by pressing the reject lever.

Adjustment

The Gold Mech Acceptors are factory adjusted for optimum performance. If more critical adjustments are desired, or if the unit has been disassembled, the following adjustment procedure is suggested. (Fig. 4)

1. Ensure that the mechanism is in an upright and level position.
2. Loosen the hex locking screw on the magnet holder and unscrew the slotted hex screw.
3. Place a true U.S. 25¢ coin in the mechanism. Turn the diameter adjustment (Fig. 4) clockwise until the coin falls into the cradle. The cradle should tip and the coin come to rest on the side of the magnet. Turn the slotted hex screw clockwise until the coin just clears the magnet. Give this screw a further 1/2 turn clockwise for optimum clearance and tighten the locknut.

Part Number	Description
12-4150-01	Gold Mech Acceptor
90-1000-00	Keyhook Bezel Screw
90-1007-00	Flat Head Microswitch Mounting Screw
90-1008-00	Pan Head Microswitch Mounting Screw
90-1016-00	CPJS/Bezel Screw
90-1030-00	Mounting Screw for Gold Mech
90-1032-00	Bezel/Hinge Screw PZ
90-1109-00	Lock Washer for Microswitch Assembly
90-1207-00	Nut for Microswitch Mounting Screw
91-1103-00	Coin Inlet Lamp Side
91-1104-00	Coin Inlet Cover Side
91-1105-00	Reject Cup Side Plate
91-1106-00	Reject Cup Base Plate
91-1107-00	Microswitch Bracket
91-1108-00	Lockout Flap U.S. 25¢
91-1109-16	Reject Flap
91-1110-00	Metal Switch Adjuster
91-1113-01	Entry/Reject Button U.S. 25¢
91-1116-10	Microswitch (Red End Arm)
91-1117-00	Lampholder
91-1118-00	GV Wedge Base Lamp
91-1120-00	Lockout Spring
91-1121-00	Button Spring
91-1125-00	Clear Plastic Cover for Microswitch
91-1141-00	Base Plate w/Pivot Coil
91-1145-00	12V DC Lockout Coil
91-1311-16	Black Nylon Button Bezel
91-1312-16	Black Nylon Reject Bezel

USER INFORMATION
WARNING
F. C. C. REGULATION COMPLIANCE

THIS KIT IS INTENDED FOR USE ONLY ON COIN-OPERATED VIDEO GAMES MANUFACTURED AFTER OCTOBER 1, 1983 WHICH HAVE BEEN VERIFIED FOR COMPLIANCE WITH REQUIREMENTS IN PART 15 OF F.C.C. RULES FOR A CLASS A COMPUTING DEVICE.

IMPROPER CONNECTION OF THIS KIT OR CONNECTION TO ANY OTHER GAME NOT SO MANUFACTURED OR VERIFIED FOR COMPLIANCE MAY CAUSE UNACCEPTABLE INTERFERENCE TO RADIO AND T.V. RECEPTION, REQUIRING THE OPERATOR TO TAKE WHATEVER STEPS ARE NECESSARY TO CORRECT THE INTERFERENCE.

THE P.C. BOARD CAGE SUPPLIED WITH THIS CONVERSION KIT MUST BE UTILIZED AND TERMINATED TO GROUND AT THE TIME OF INSTALLATION.



815 Mittel Drive, Wood Dale, Illinois 60191
Telephone: (312) 595-1443, Telex: 6871385 KONAM UW, Fax: (312) 595-2973

A

B

C

D

E

F

1

2

3

4

5

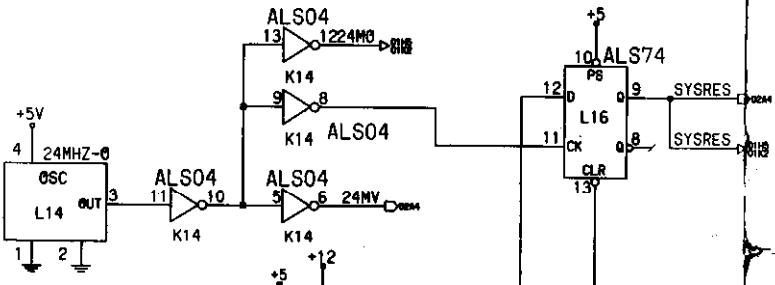
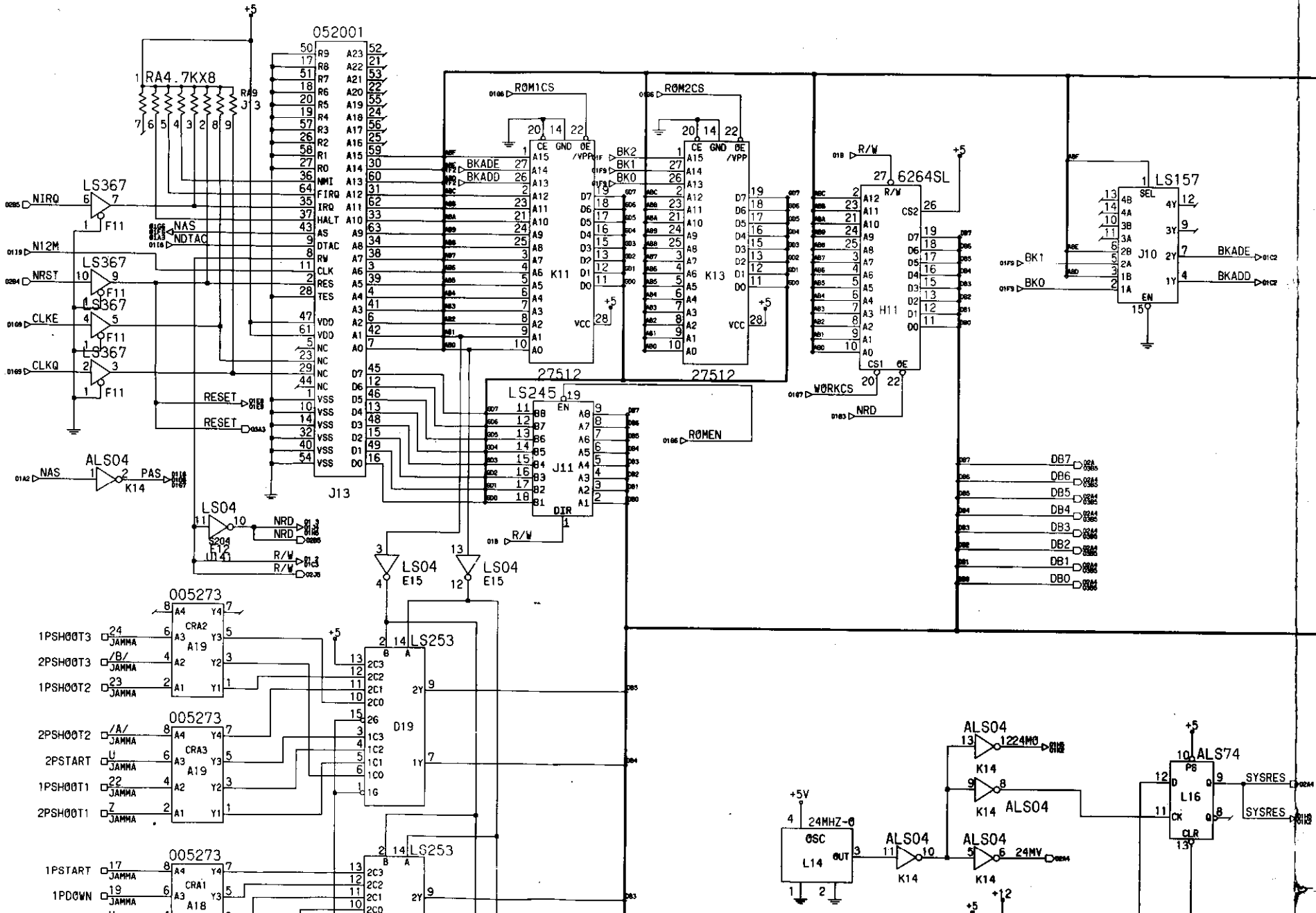

5

6

7

8

9

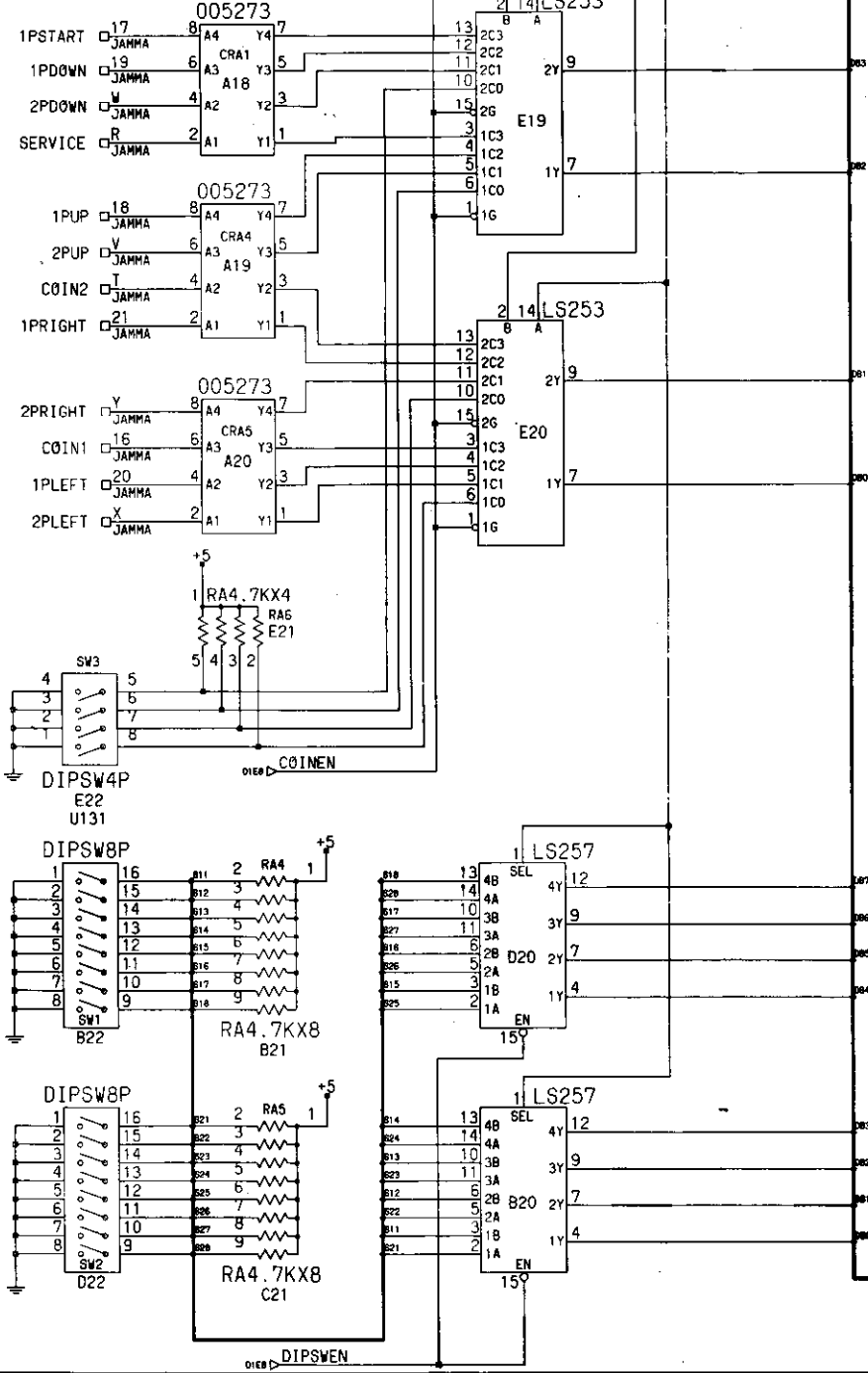

A

B

C

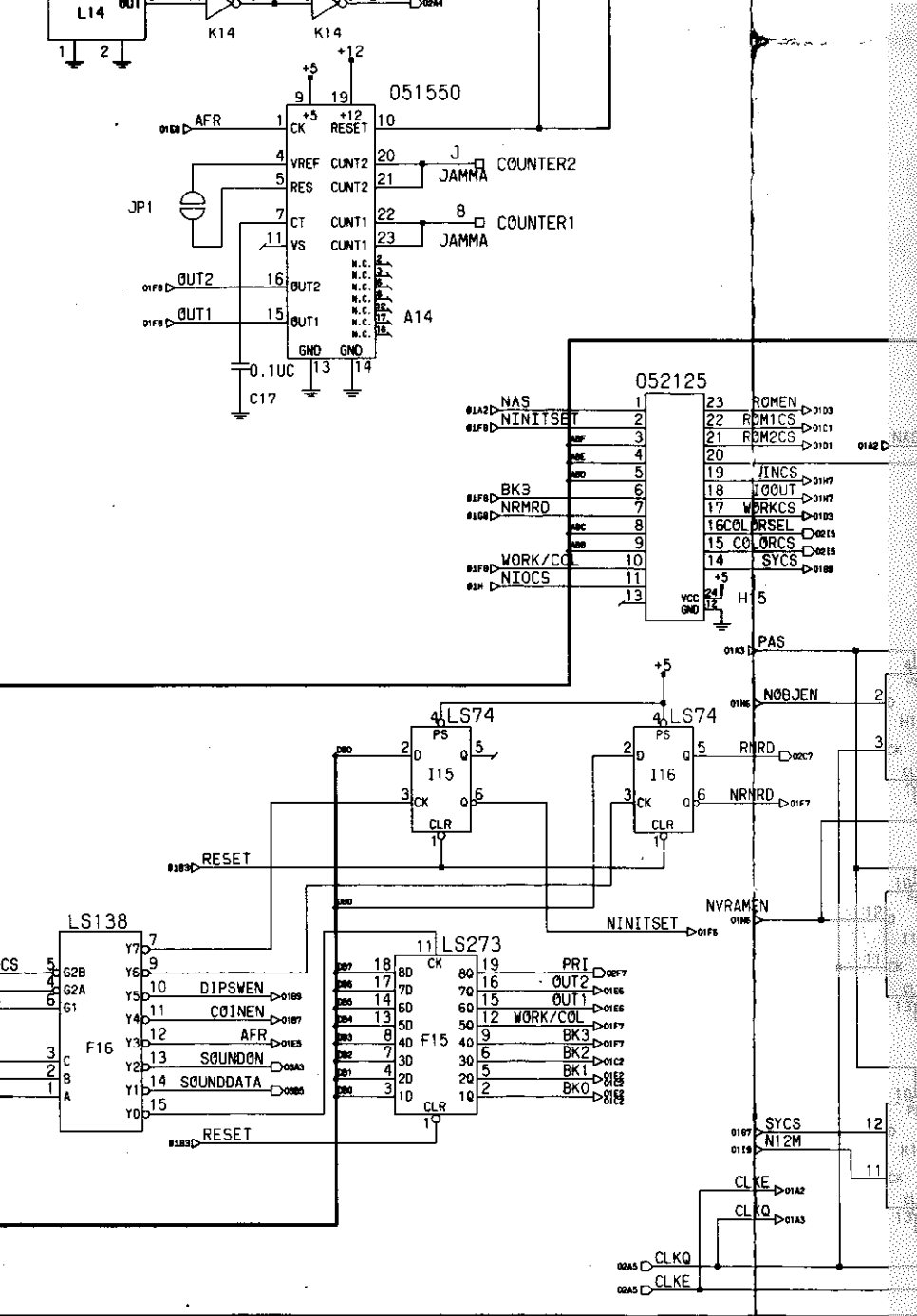

D

E

F

G

G

H

I

J

K

L

051937

90	RAOE	0811	48
89	CA3W	0810	47
88	CA2W	0809	46
87	CA1W	0808	45
86	CA0W	0807	44
85	CD37	0806	43
84	CD36	0805	42
83	CD35	0804	41
82	CD34	0803	40
81	CD33	0802	39
80	CD32	0801	38
79	CD31	0800	37
78	CD30	0800	36
77	PCOF	0800	35
76	NC00	0800	34
75	CD27	0800	33
74	CD26	0800	32
73	CD25	0800	31
72	CD24	0800	30
71	CD23	0800	29
70	CD22	0800	28
69	CD21	0800	27
68	CD20	0800	26
67	CD17	0800	25
66	CD16	0800	24
65	CD15	0800	23
64	CD14	0800	22
63	CD13	0800	21
62	CD12	0800	20
61	CD11	0800	19
60	CD10	0800	18
59	CD07	0800	17
58	CD06	0800	16
57	CD05	0800	15
56	CD04	0800	14
55	CD03	0800	13
54	CD02	0800	12
53	CD01	0800	11
52	CD00	0800	10
51	OC7	0800	9
50	OC6	0800	8
49	OC5	0800	7
48	OC4	0800	6
47	OC3	0800	5
46	OC2	0800	4
45	OC1	0800	3
44	OC0	0800	2
43	HP8	0800	1
42	HP7	0800	0
41	HP6	0800	0
40	HP5	0800	0
39	HP4	0800	0
38	HP3	0800	0
37	HP2	0800	0
36	HP1	0800	0
35	HP0	0800	0
34	CARY	0800	0
33	LACH	0800	0
32	HEND	0800	0
31	OREG	0800	0
30	DHF	0800	0
29	IRQ	0800	0
28	FRQ	0800	0
27	NMI	0800	0
26	RST	0800	0
25	NG	0800	0
24	M12	0800	0
23	RES	0800	0
22	VCC	0800	0
21	VCC	0800	0
20	VCC	0800	0
19	VCC	0800	0
18	VCC	0800	0
17	VCC	0800	0
16	VCC	0800	0
15	VCC	0800	0
14	VCC	0800	0
13	VCC	0800	0
12	VCC	0800	0
11	VCC	0800	0
10	VCC	0800	0
9	VCC	0800	0
8	VCC	0800	0
7	VCC	0800	0
6	VCC	0800	0
5	VCC	0800	0
4	VCC	0800	0
3	VCC	0800	0
2	VCC	0800	0
1	VCC	0800	0

CA7	A22	CN3	A32
CA6	CN3	A21	CN3
CA5	A20	CN3	A31
CA4	CN3	A19	CN3
CA3	A18	CN3	A30
CA2	CN3	A17	CN3
CA1	A16	CN3	A29
CA0	CN3	A15	CN3
			A28
			CN3
			A27
			CN3
			A26
			CN3
			A25
			CN3
			A24
			CN3

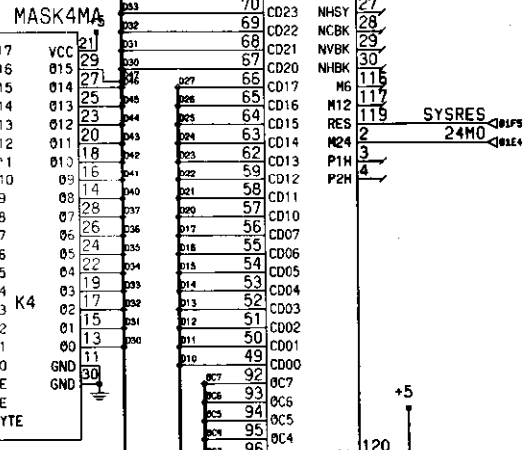
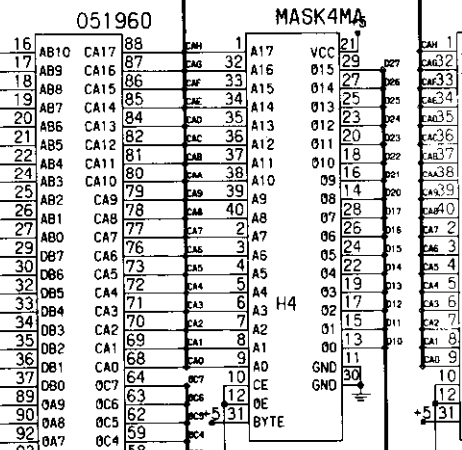

90	RAOE	0811	48
89	CA3W	0810	47
88	CA2W	0809	46
87	CA1W	0808	45
86	CA0W	0807	44
85	CD37	0806	43
84	CD36	0805	42
83	CD35	0804	41
82	CD34	0803	40
81	CD33	0802	39
80	CD32	0801	38
79	CD31	0800	37
78	CD30	0800	36
77	PCOF	0800	35
76	NC00	0800	34
75	CD27	0800	33
74	CD26	0800	32
73	CD25	0800	31
72	CD24	0800	30
71	CD23	0800	29
70	CD22	0800	28
69	CD21	0800	27
68	CD20	0800	26
67	CD17	0800	25
66	CD16	0800	24
65	CD15	0800	23
64	CD14	0800	22
63	CD13	0800	21
62	CD12	0800	20
61	CD11	0800	19
60	CD10	0800	18
59	CD07	0800	17
58	CD06	0800	16
57	CD05	0800	15
56	CD04	0800	14
55	CD03	0800	13
54	CD02	0800	12
53	CD01	0800	11
52	CD00	0800	10
51	OC7	0800	9
50	OC6	0800	8
49	OC5	0800	7
48	OC4	0800	6
47	OC3	0800	5
46	OC2	0800	4
45	OC1	0800	3
44	OC0	0800	2
43	HP8	0800	1
42	HP7	0800	0
41	HP6	0800	0
40	HP5	0800	0
39	HP4	0800	0
38	HP3	0800	0
37	HP2	0800	0
36	HP1	0800	0
35	HP0	0800	0
34	CARY	0800	0
33	LACH	0800	0
32	HEND	0800	0
31	OREG	0800	0
30	DHF	0800	0
29	IRQ	0800	0
28	FRQ	0800	0
27	NMI	0800	0
26	RST	0800	0
25	NG	0800	0
24	M12	0800	0
23	RES	0800	0
22	VCC	0800	0
21	VCC	0800	0
20	VCC	0800	0
19	VCC	0800	0
18	VCC	0800	0
17	VCC	0800	0
16	VCC	0800	0
15	VCC	0800	0
14	VCC	0800	0
13	VCC	0800	0
12	VCC	0800	0
11	VCC	0800	0
10	VCC	0800	0
9	VCC	0800	0
8	VCC	0800	0
7	VCC	0800	0
6	VCC	0800	0
5	VCC	0800	0
4	VCC	0800	0
3	VCC	0800	0
2	VCC	0800	0
1	VCC	0800	0

SYSRES 24MO
M24
P1H
P2H



VDD	120
VDD	104
VDD	74
VDD	60
VDD	44
VDD	14
VSS	105
VSS	91
VSS	83
VSS	75
VSS	61
VSS	45
VSS	31
VSS	23
VSS	15
VSS	1
VSS	9
TE1	118
TE0	

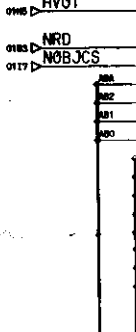
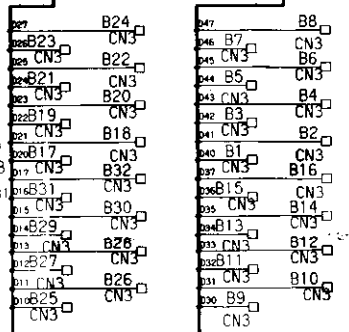

ABF	02A2
ABE	02A3
ABD	02A3
ABC	02A3
ABB	02A3
ABA	02A3
AB9	02A3
AB8	02A3
AB7	02A3
AB6	02A3
AB5	02A3
AB4	02A3
AB3	02A3
AB2	02A3
AB1	02A3

SYSRES	119
24MO	2
M24	3
P1H	4
P2H	5
HV0T	6
HV0T	7
PO	8
PE	9
WRP	10
WRN	11
RDN	12
NRD	13
NOBJCS	13

BKADE 01C2
BKADD 01C2

ALS74
9 SYSRES 02A4
SYSRES 01B2

1

2

3

4

5

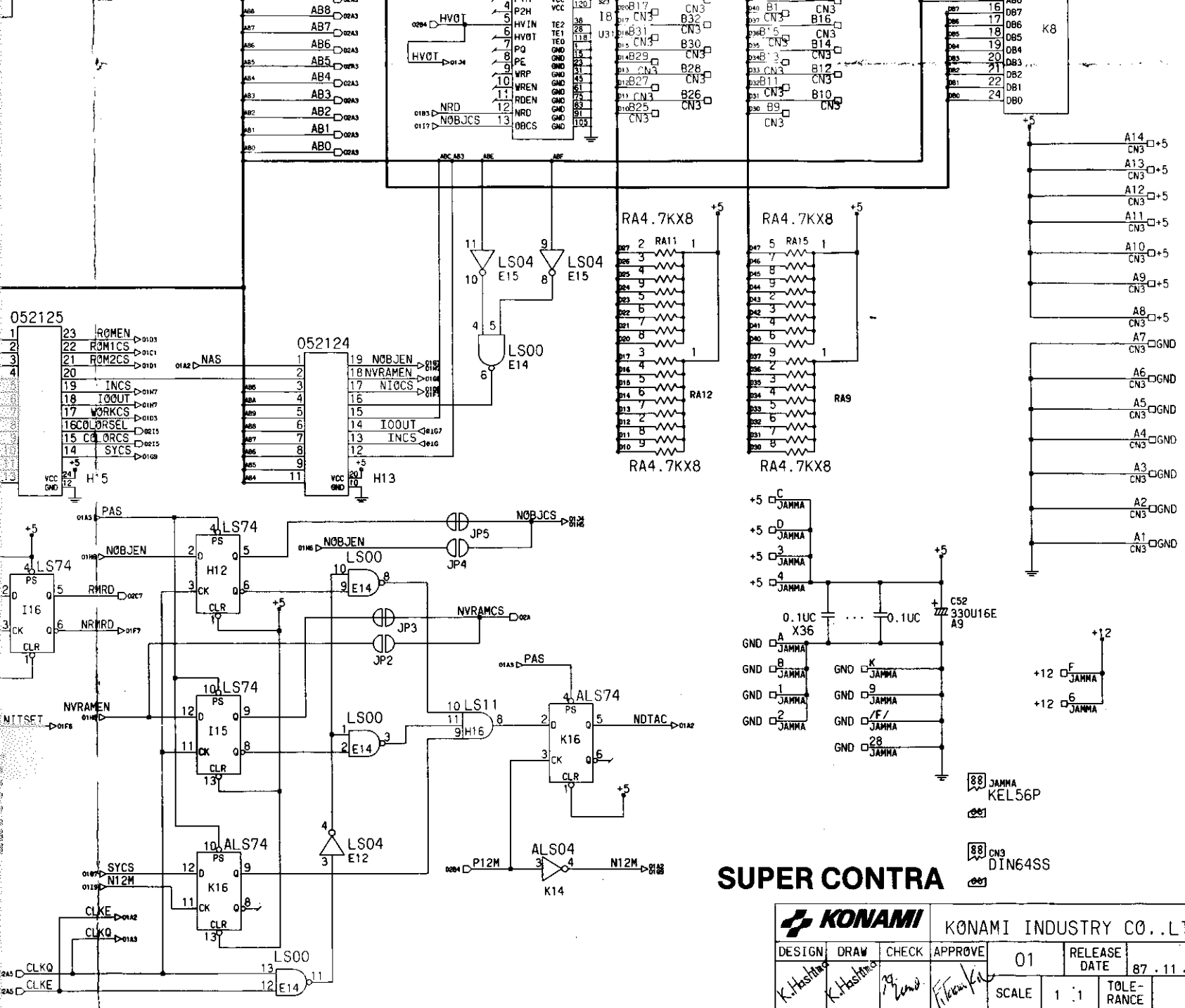

-NOTE-

KINDS OF CAPACITOR
 T:TANTALUM
 M:MYLAR
 E:ELECTROLYTIC
 NØMARK:CERAMIC

+5 : VCC (5V)
 +12 : VCC (12V)
 ⚡ : GND

JAMMA □ JAMMA EDGE 56PIN
 CN3 □ CN3:64PIN DIN CONNECTOR SOCKET
 → : ON PAGE SIGNAL
 ⇨ : OFF PAGE SIGNAL

PIN NØ.
 NUMBER:PARTS SIDE
 ALPHABET:SOLDER SIDE
 /A/ A SMALL LETTER

SUPER CONTRA

				KONAMI INDUSTRY CO.,LTD.				REG. TYPE	SCHMATIC DIAGRAM
DESIGN	DRAW	CHECK	APPROVE	01	RELEASE DATE	87.11.18	NAME	GX775 PWB350794A	
K. Hashida			K. Hashida		Z. Zeno		F. Hashida		
SCALE				1:1	TOLERANCE		CODE NO.	100082 1/3	

G H I J K L

A B C D E F

1

2

3

4

5

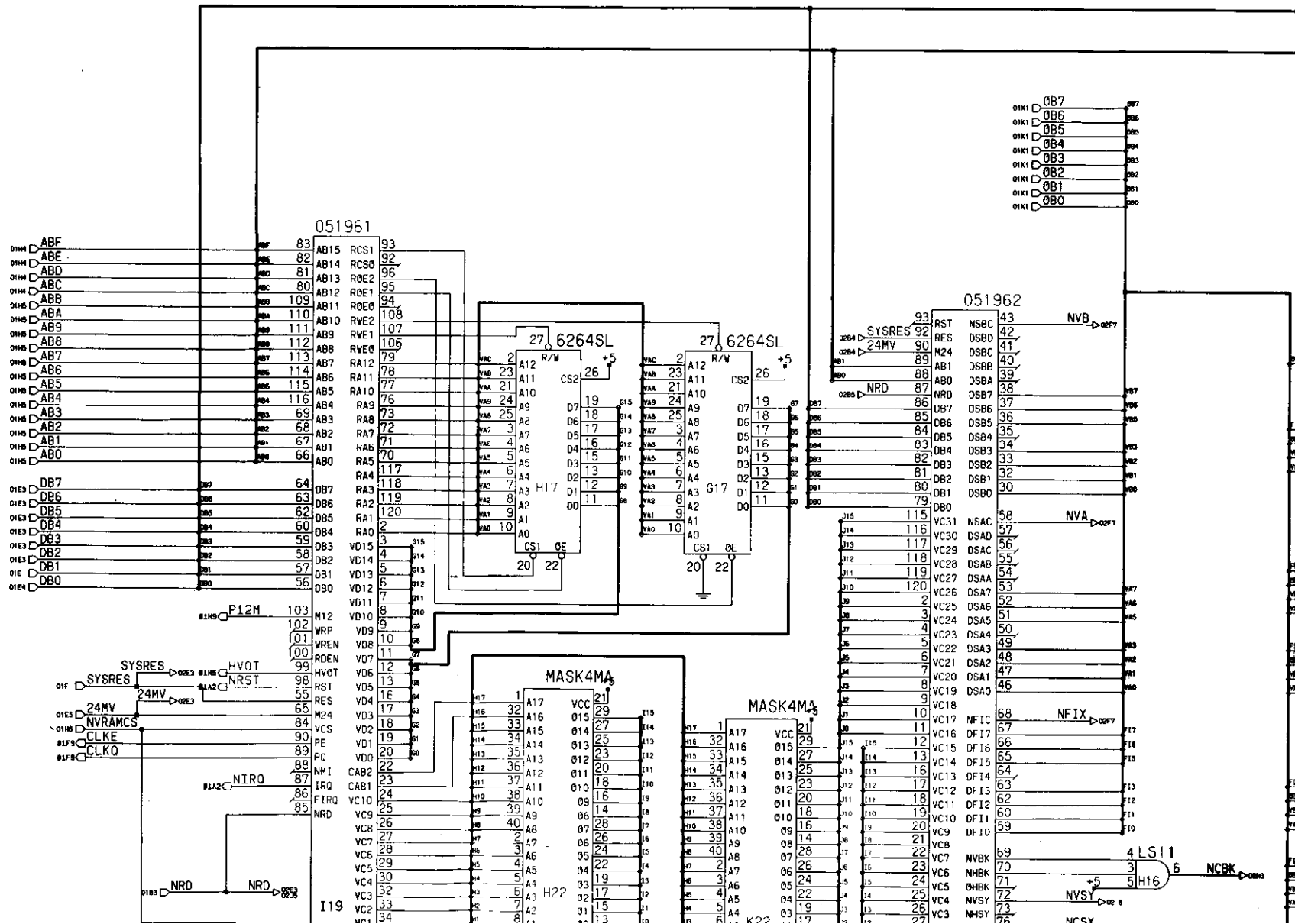

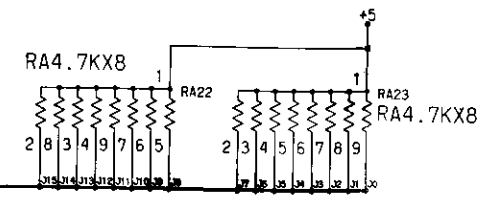
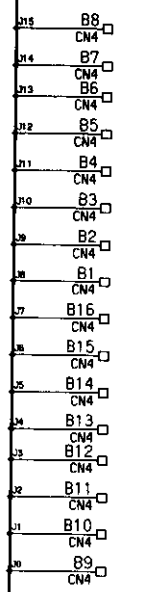
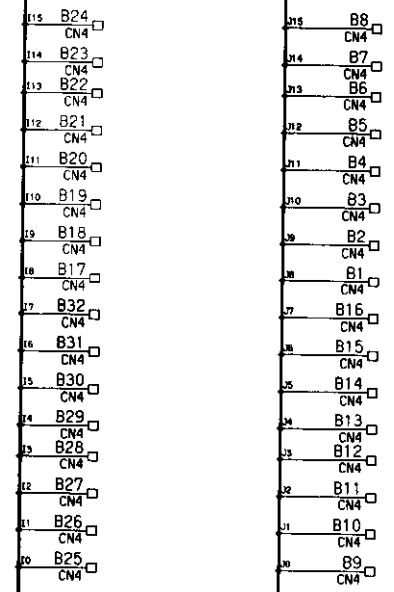
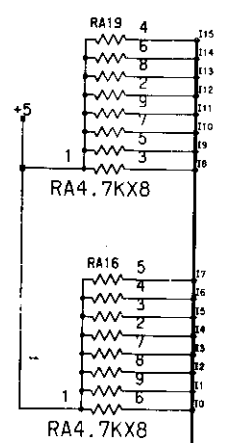
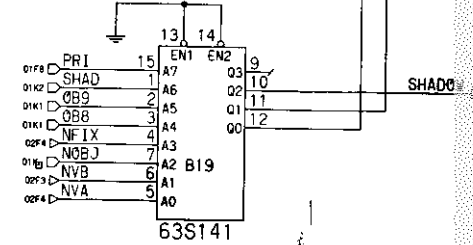
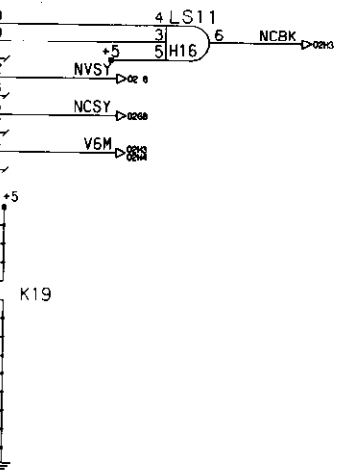
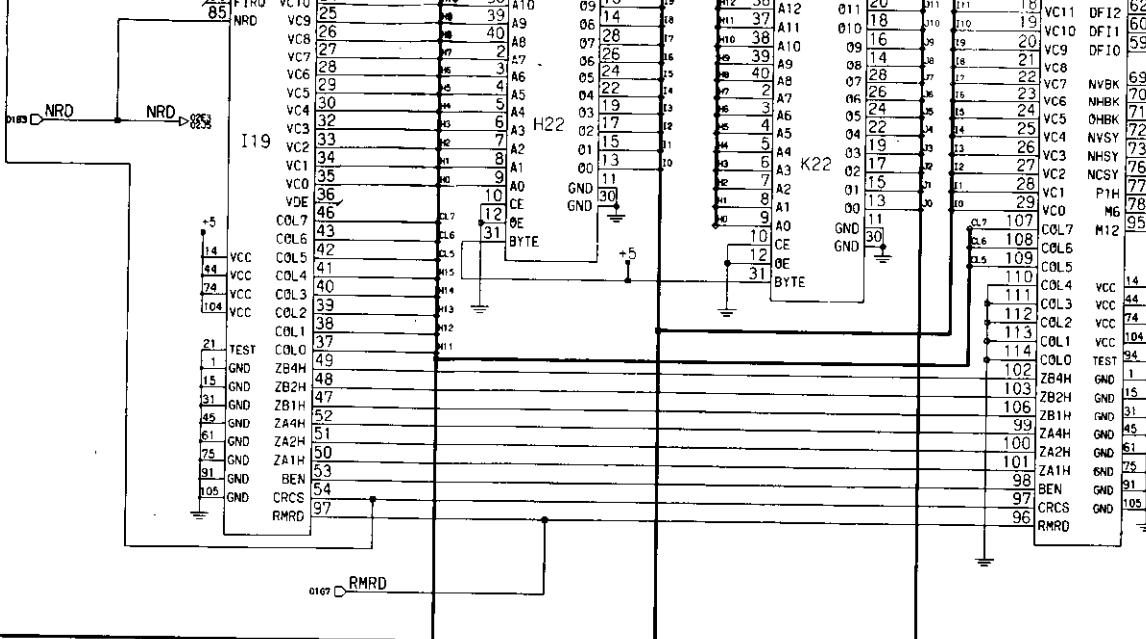
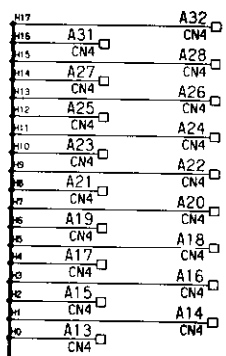

A B C D E F G

5
6
7
8
9

G

H

I

J

K

L

1

2

3

4

5

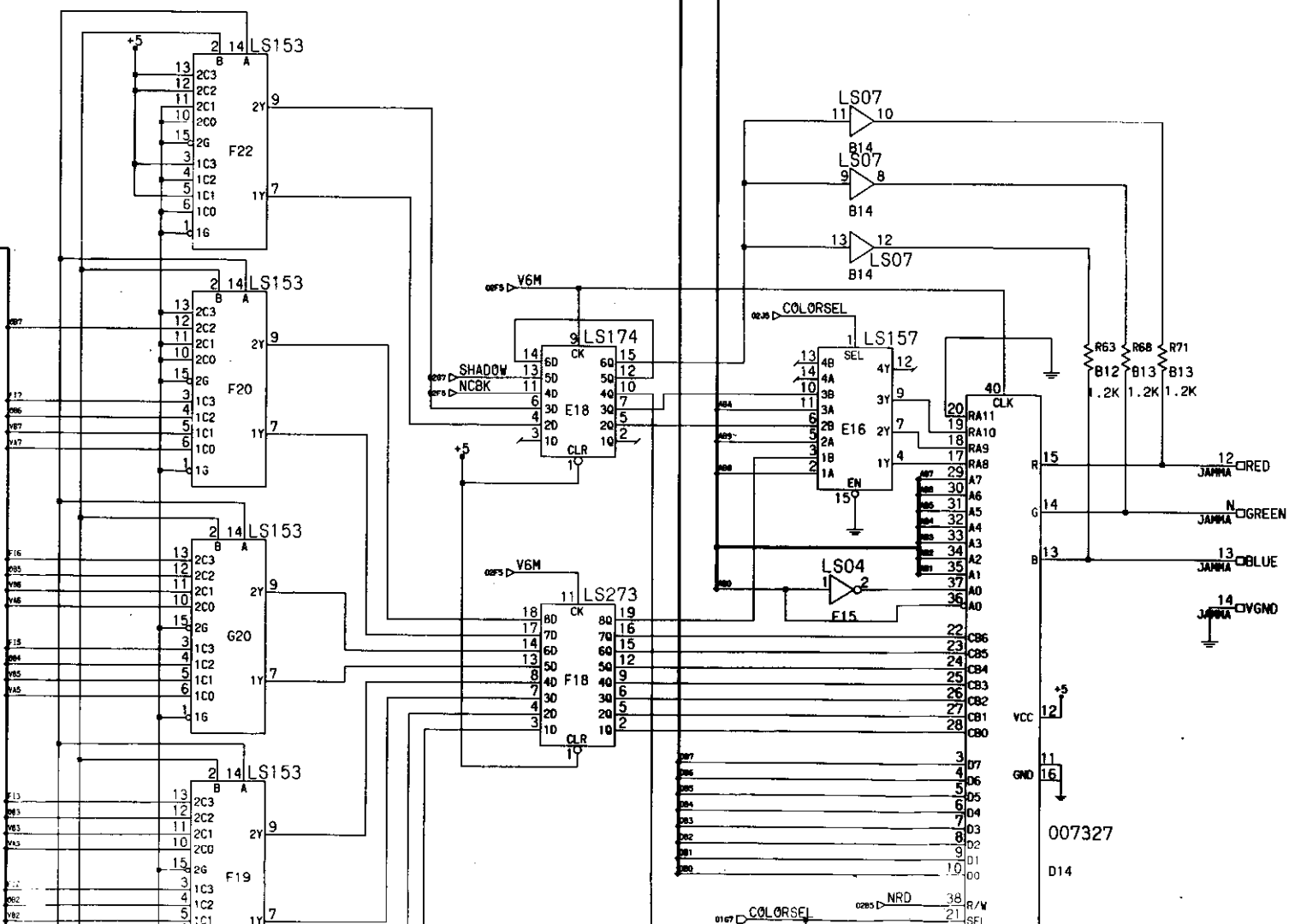

NCBK

007327

+5

VCC

GND

D14

0167 COLORSEL

0265 NRD

38 R/W
21 SEL

07
06
05
04
03
02
01
00

22 CB6
23 CB5
24 CB4
25 CB3
26 CB2
27 CB1
28 CB0

15 R
14 G
13 B
12 JANNA RED
11 JANNA GREEN
10 JANNA BLUE
9 JANNA GND

R63 R68 R71
B12 B13 B13
.2K 1.2K 1.2K

LS07
LS07
LS07
B14
B14
B14

LS157
SEL
EN
A7
A6
A5
A4
A3
A2
A1
A0
37
36
35
34
33
32
31
30
29
17
18
19
20
21
22
23
24
25
26
27
28
29
30
31
32
33
34
35
36
37
38
39
40
41
42
43
44
45
46
47
48
49
50
51
52
53
54
55
56
57
58
59
60
61
62
63
64
65
66
67
68
69
70
71
72
73
74
75
76
77
78
79
80
81
82
83
84
85
86
87
88
89
90
91
92
93
94
95
96
97
98
99
100

LS174
SHADOW
NCBK
V6M
E18
CLR
10
11
12
13
14
15
16
17
18
19
20
21
22
23
24
25
26
27
28
29
30
31
32
33
34
35
36
37
38
39
40
41
42
43
44
45
46
47
48
49
50
51
52
53
54
55
56
57
58
59
60
61
62
63
64
65
66
67
68
69
70
71
72
73
74
75
76
77
78
79
80
81
82
83
84
85
86
87
88
89
90
91
92
93
94
95
96
97
98
99
100

LS273
V6M
CLR
10
11
12
13
14
15
16
17
18
19
20
21
22
23
24
25
26
27
28
29
30
31
32
33
34
35
36
37
38
39
40
41
42
43
44
45
46
47
48
49
50
51
52
53
54
55
56
57
58
59
60
61
62
63
64
65
66
67
68
69
70
71
72
73
74
75
76
77
78
79
80
81
82
83
84
85
86
87
88
89
90
91
92
93
94
95
96
97
98
99
100

LS153
2C3
2C2
2C1
2C0
2G
1C3
1C2
1C1
1C0
1G
2Y
1Y

LS153
2C3
2C2
2C1
2C0
2G
1C3
1C2
1C1
1C0
1G
2Y
1Y

LS153
2C3
2C2
2C1
2C0
2G
1C3
1C2
1C1
1C0
1G
2Y
1Y

LS153
2C3
2C2
2C1
2C0
2G
1C3
1C2
1C1
1C0
1G
2Y
1Y

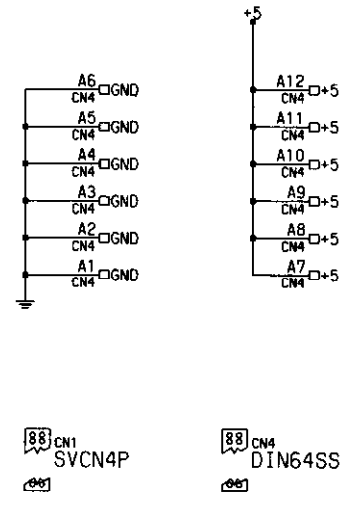
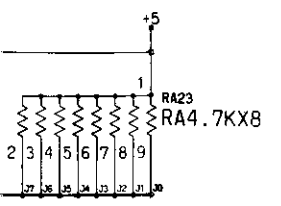
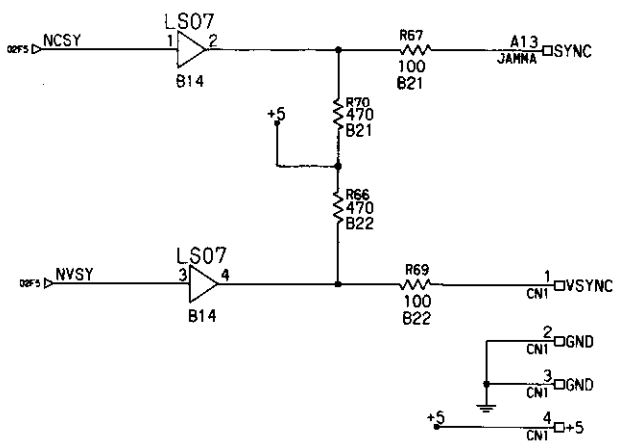
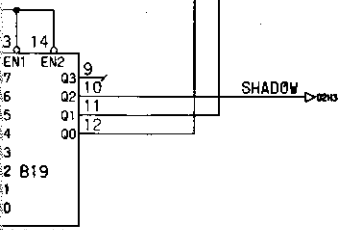
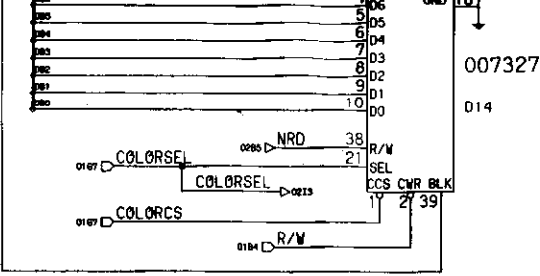
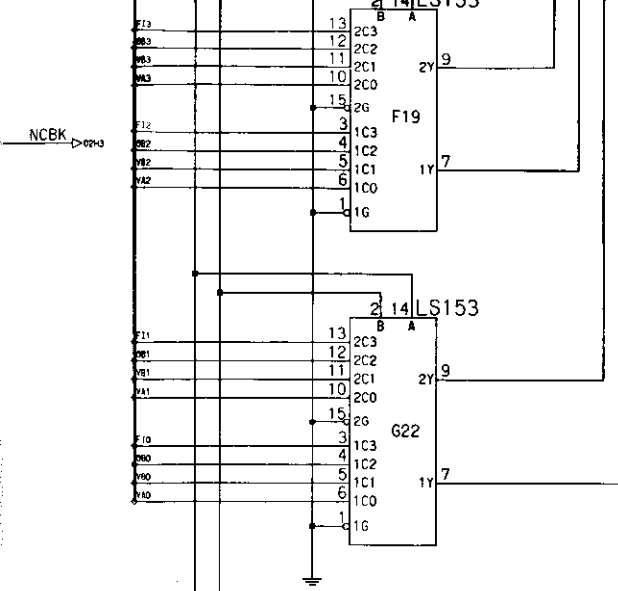

-NOTE-

KINDS OF CAPACITOR
 T: TANTALUM
 M: MYLAR
 E: ELECTROLYTIC
 N: MARK: CERAMIC

+5 : VCC (5V)
 +12 : VCC (12V)
 GND : GND

JAMMA □ JAMMA EDGE 56PIN
 CN1 □ CN1: 4PIN SV CONNECTOR
 CN4 □ CN4: 64PIN DIN CONNECTOR SOCKET
 → : ON PAGE SIGNAL
 ⇨ : OFF PAGE SIGNAL

PIN NO.
 NUMBER: PARTS SIDE
 ALPHABET: SOLDER SIDE
 /A/ A SMALL LETTER

						KONAMI INDUSTRY CO., LTD.			REG. TYPE	SCHMATIC DIAGRAM				
DESIGN	DRAW	CHECK	APPROVE	02	RELEASE DATE	87.11.18	NAME	GX775 PWB350794A						
K. Hashida				K. Hashida		M. Wada		SCALE		1:1	TOLERANCE	CODE NO.	100082 2/3	

G H I J K L

5
6
7
8
9

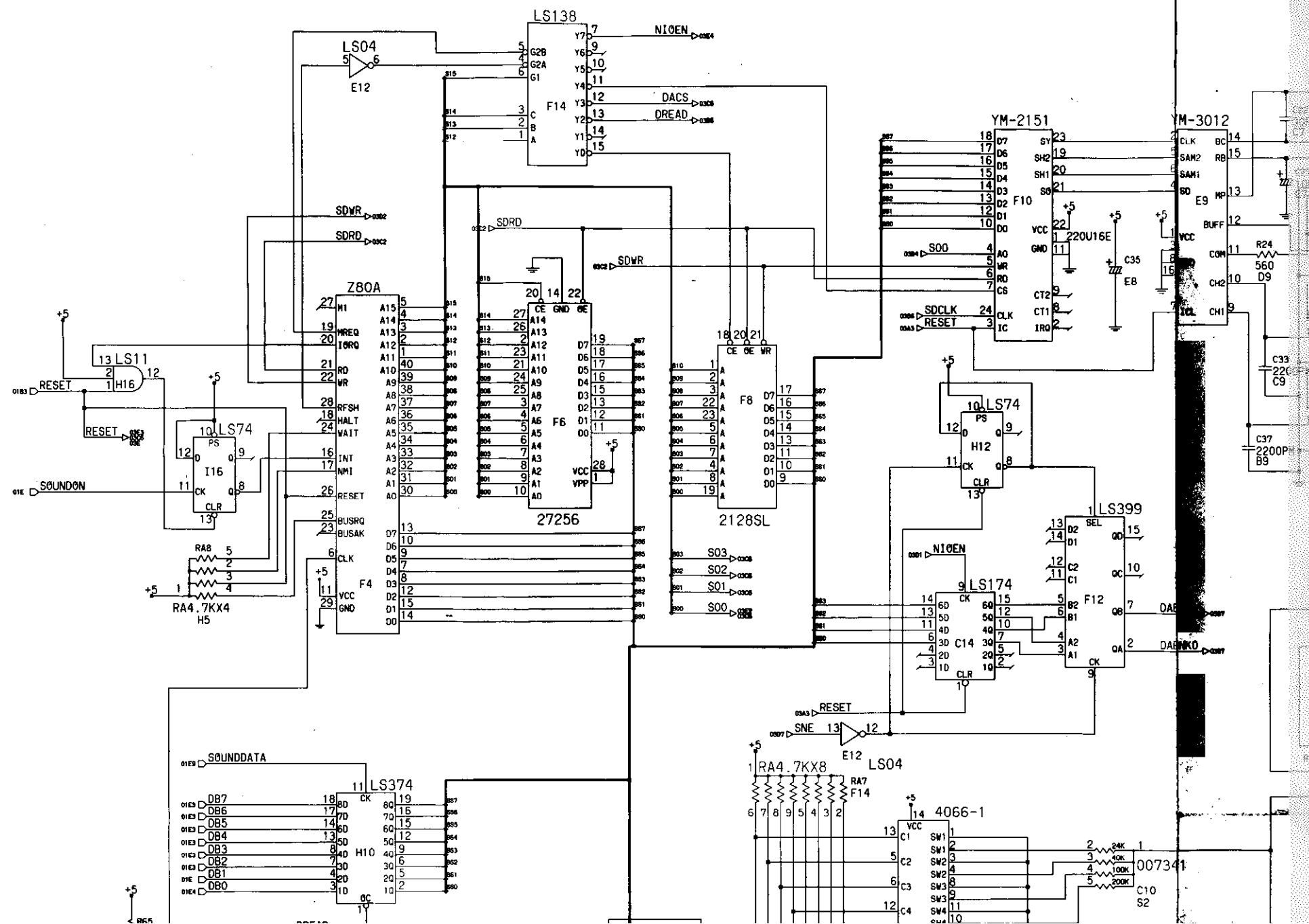

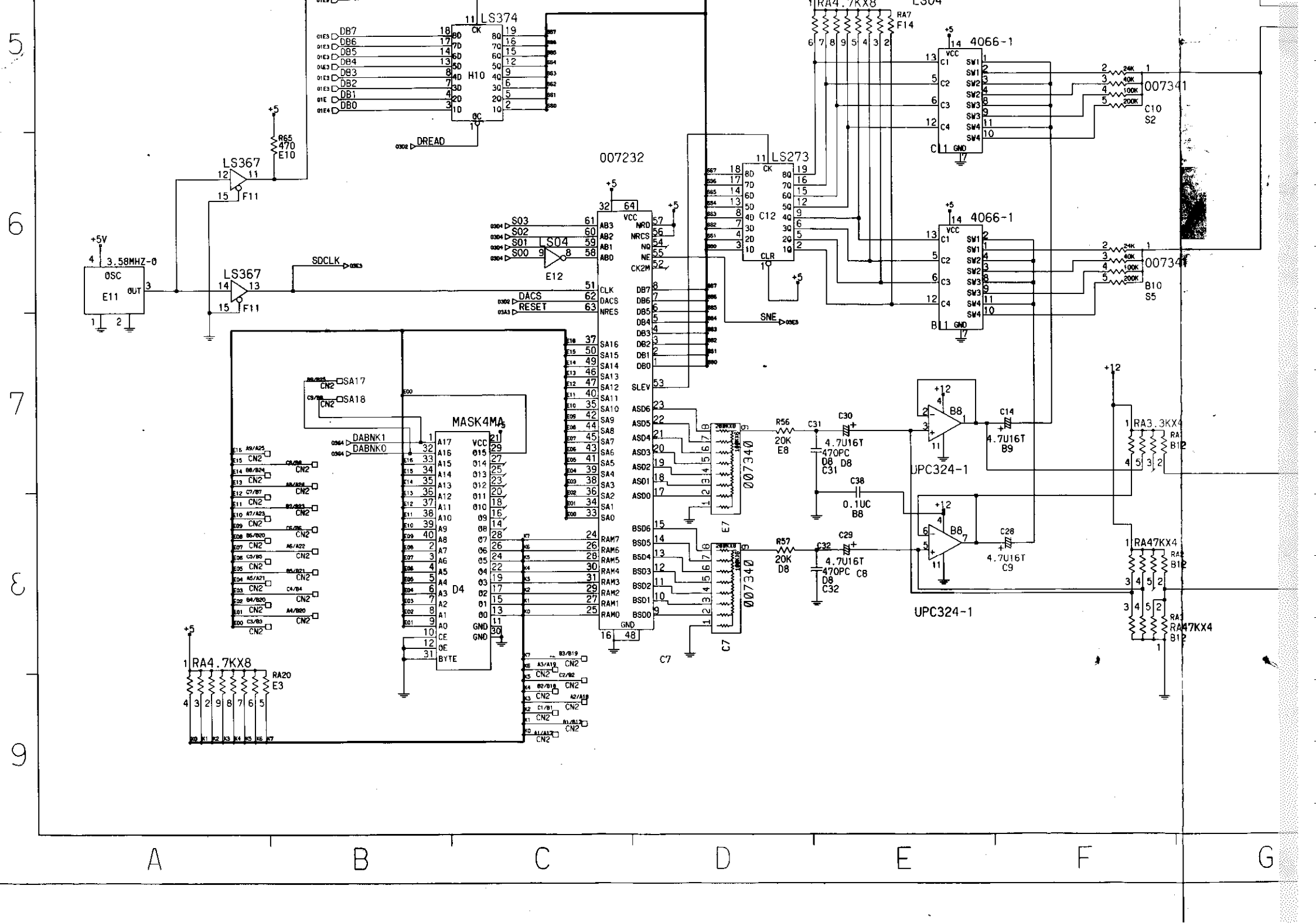

5
6
7
8
9

A B C D E F G

1

2

3

4

5

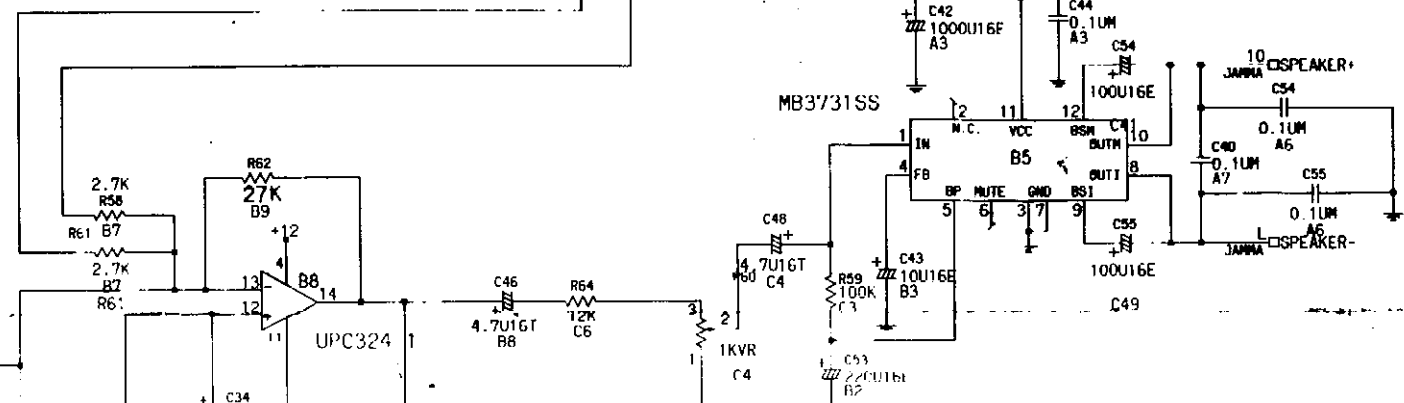
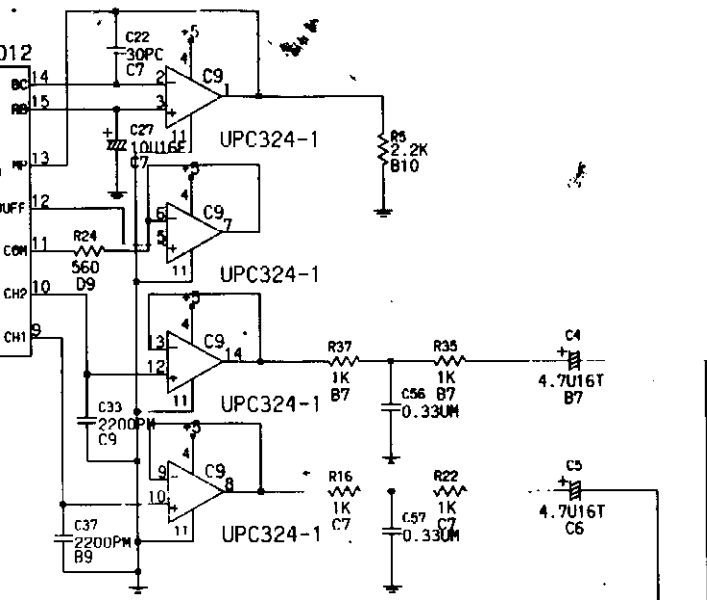

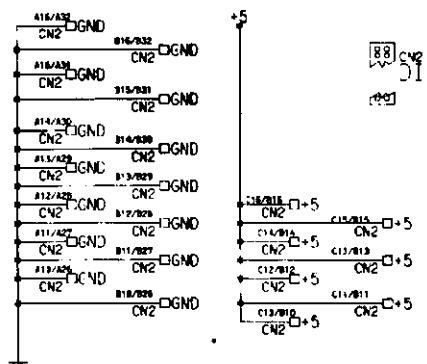
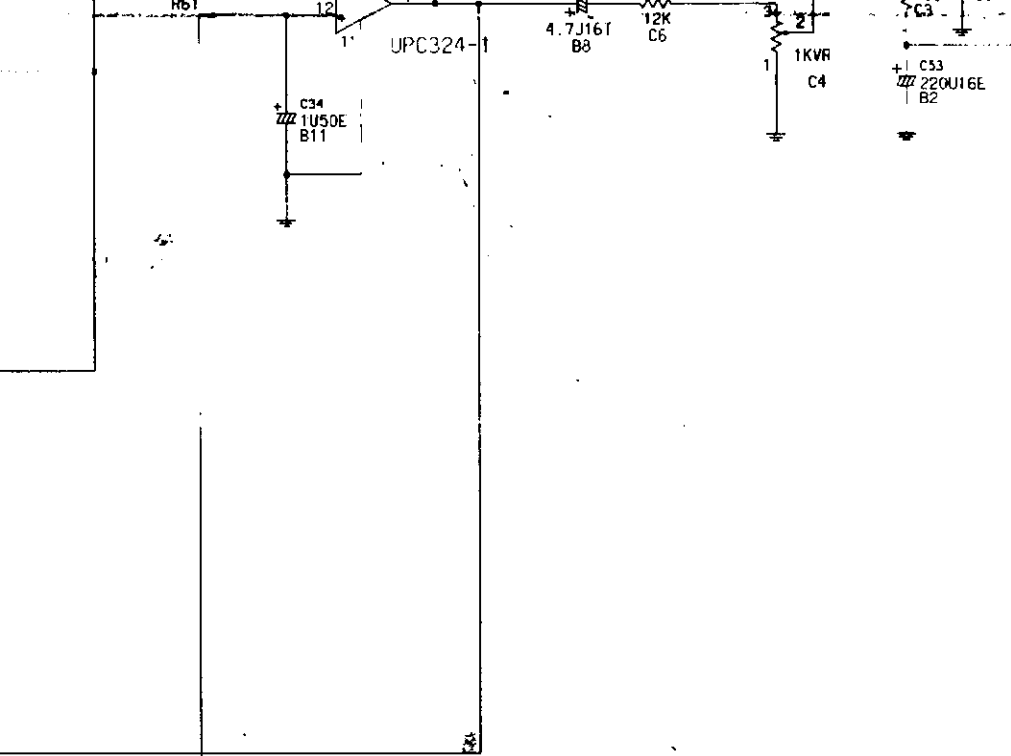

88 CN2
DIN48SS/DIN64SS

-NOTE-

KINDS OF CAPACITOR
T: TANTALUM
M: MYLAR
F: ELECTROLYTIC
NOMARK: CERAMIC
↑5 : VCC(5V)
↑12 : VCC(12V)
↓ : GND

JAMMA □ JAMMA EDGE 56PIN
CASE OF DIN48PIN
CASE OF DIN64PIN
XX/XX □ CN2: 48P/64P DIN CONNECTOR SOCKET
→ □ ON PAGE SIGNAL
⇨ □ OFF PAGE SIGNAL

PIN NO.
NUMBER: PARTS SIDE
ALPHABET: SOLDER SIDE
/A/ A SMALL LETTER

SUPER CONTRA

				KONAMI INDUSTRY CO., LTD.				REG. TYPE	SCHMATIC DIAGRAM
DESIGN	DRAW	CHECK	APPROVE	03	RELEASE DATE	87.11.18	NAME	GX775 PWB350794A	
			SCALE	1:1	TOLERANCE				
							CODE NO.	100082 3/3	

G H I J K L

5
6
7
8
9

A

B

C

D

E

F

G

1

2

3

4

5

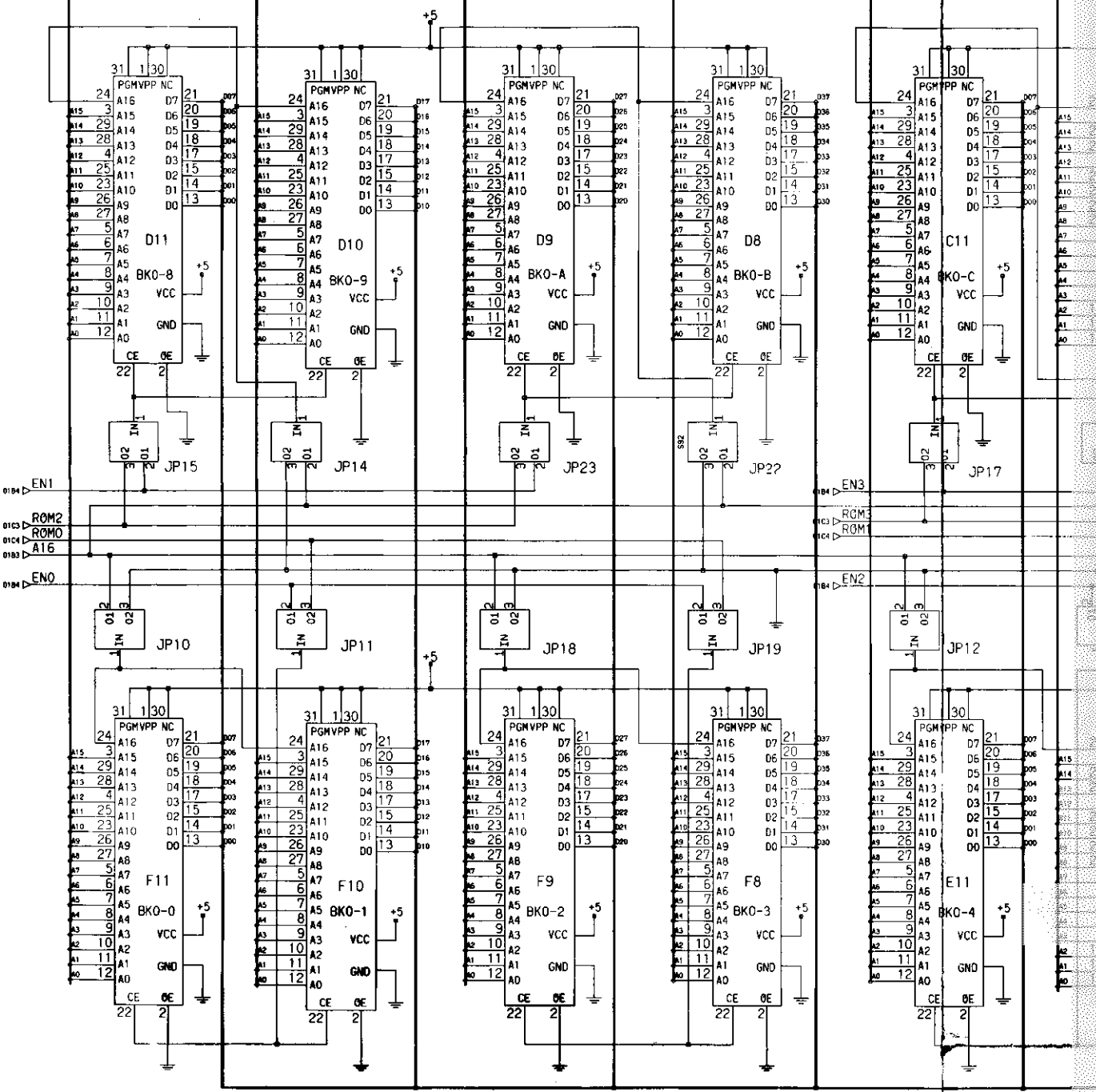
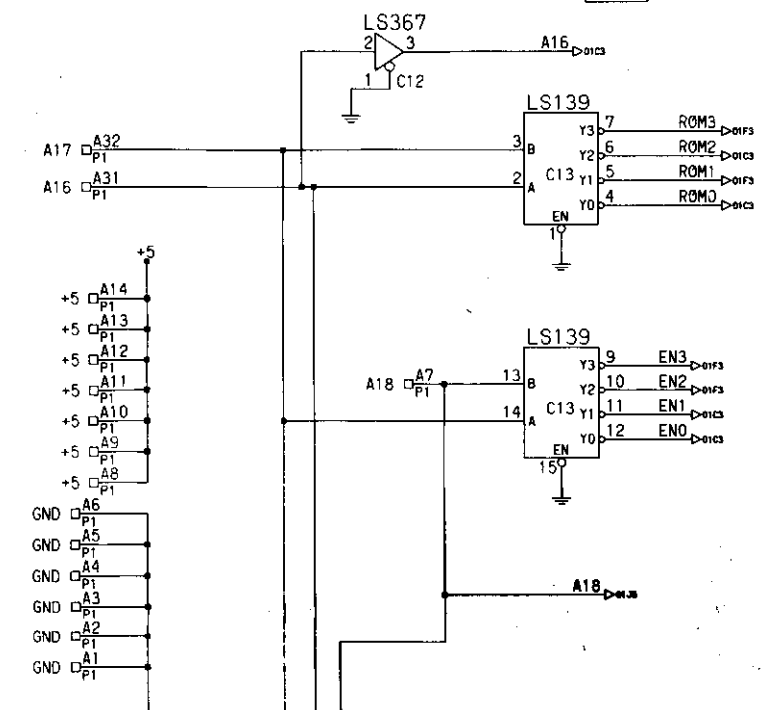
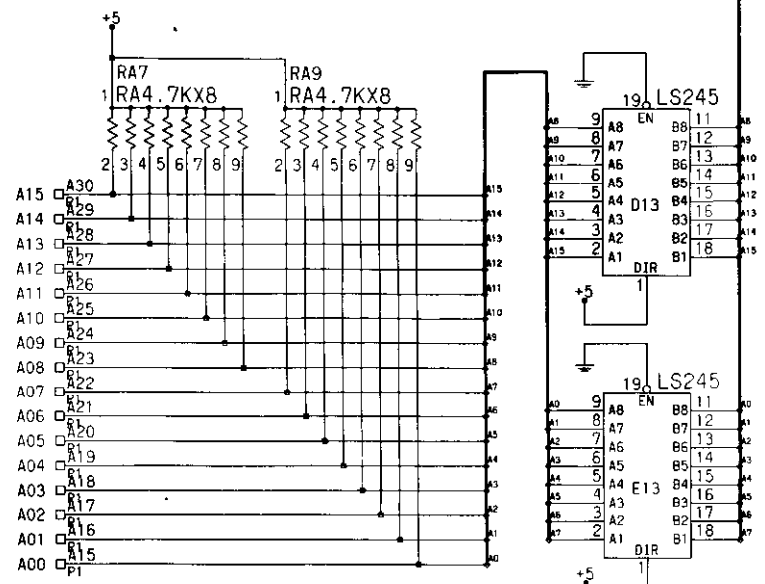

GND A5 P1
GND A4 P1
GND A3 P1
GND A2 P1
GND A1 P1

5

6

7

8

9

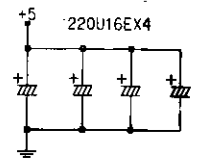
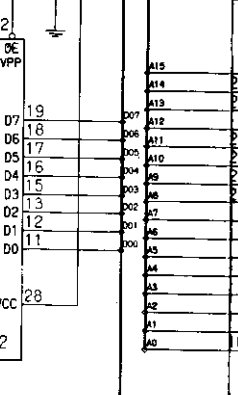
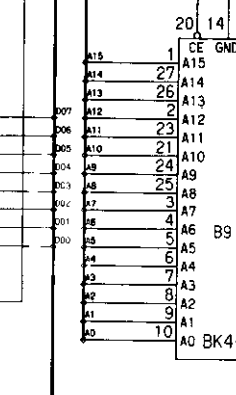
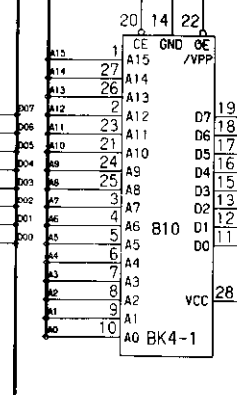
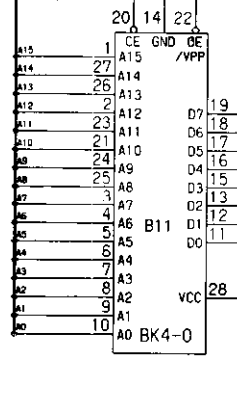
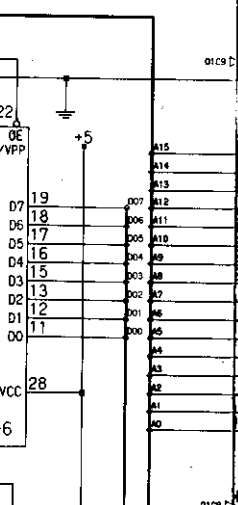
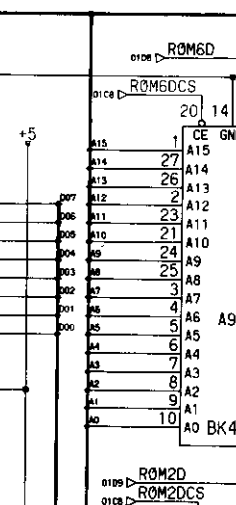
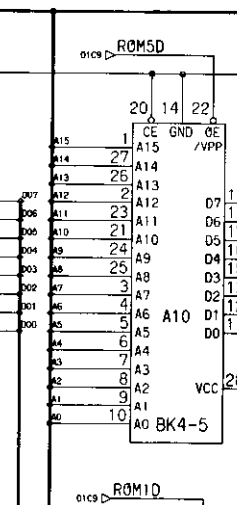
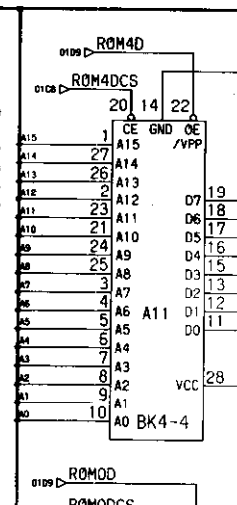
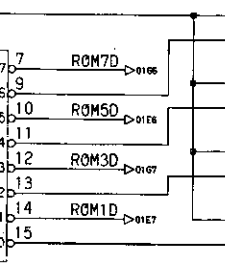
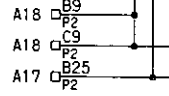
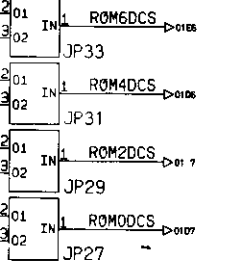
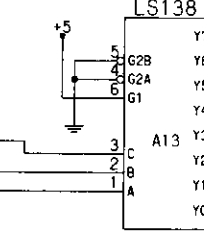
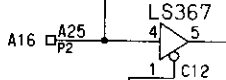
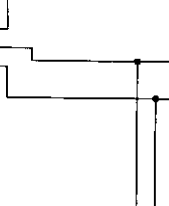
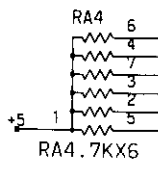
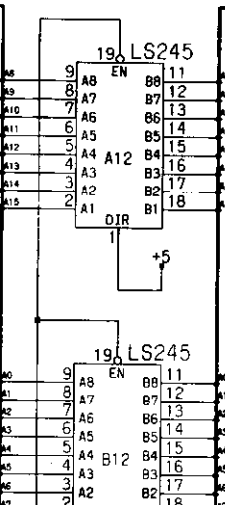
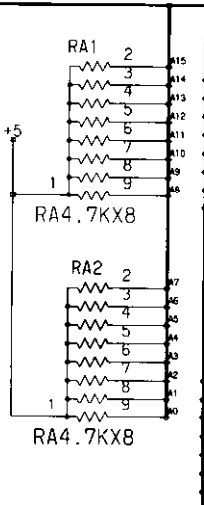
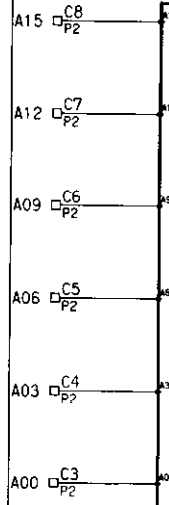
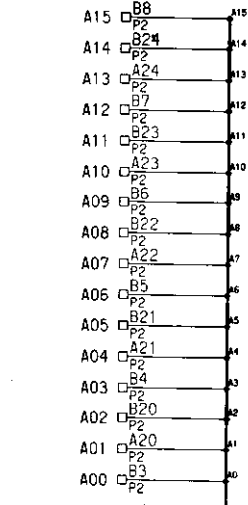

88 P1
DIN64PS
041

A

B

C

D

E

F

G

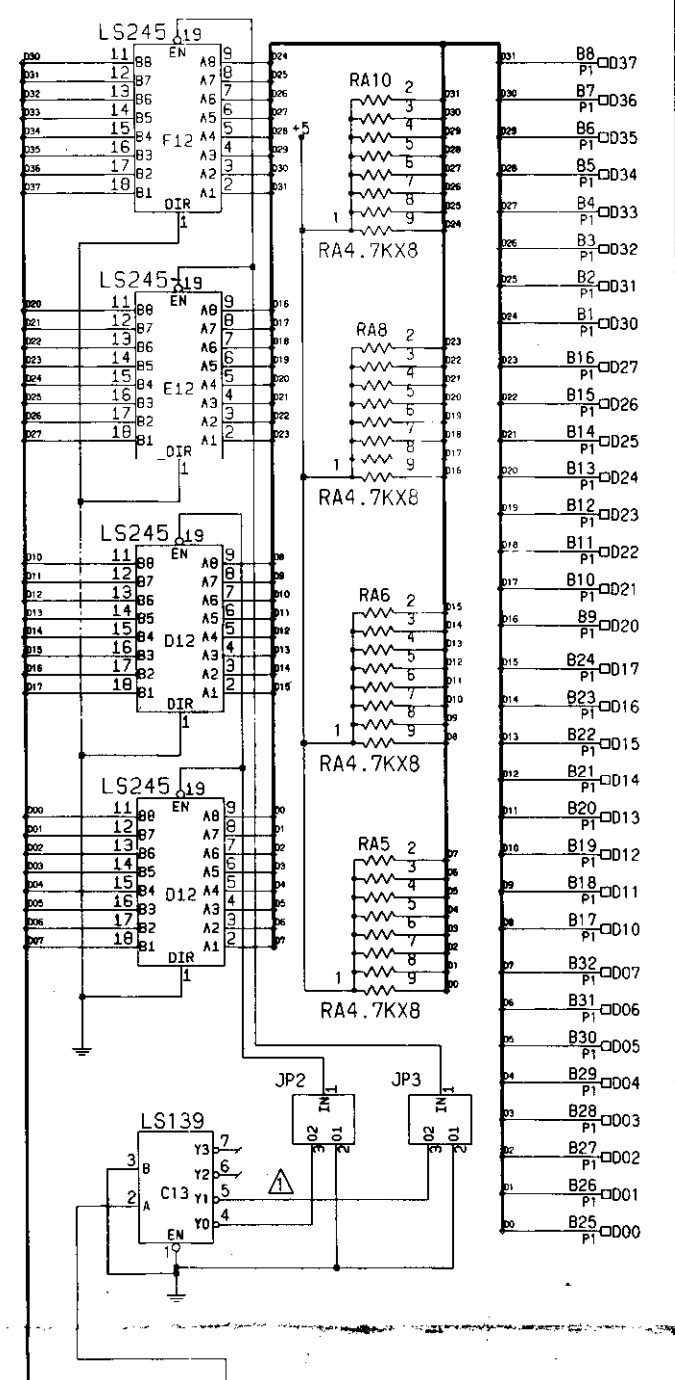
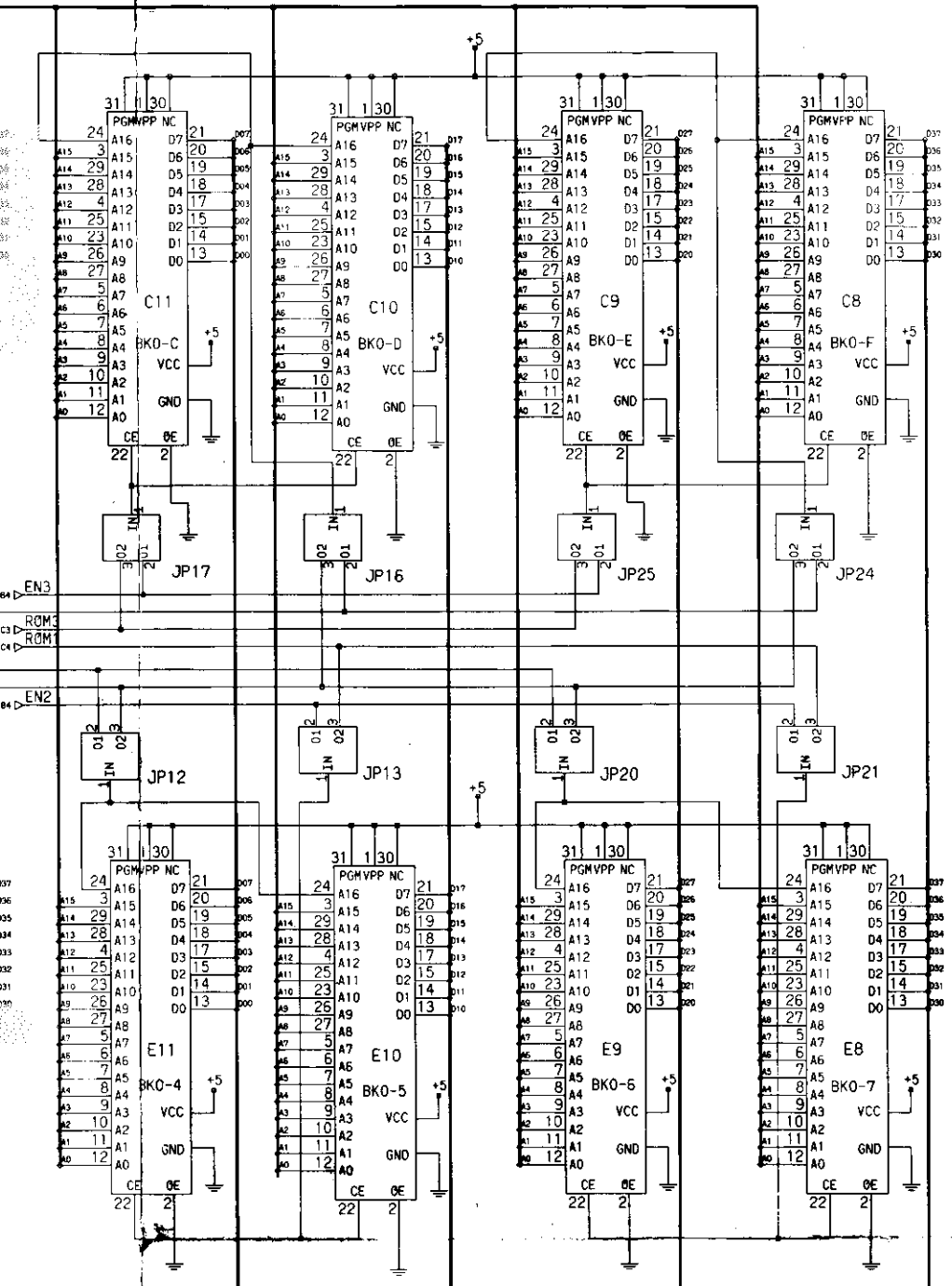

- NOTE -

+5 VCC +5V
 ⊥ GND

- P1 □ CN1: DIN64PIN PLUG
- P2 □ CN2: DIN64PIN PLUG
OR DIN48PIN PLUG
- P3 □ CN3: DIN64PIN PLUG
- P4 □ CN4: DIN64PIN PLUG

KIND OF CAPACITOR
 E: ELECTROLYTIC

HOW TO USE JUMPER

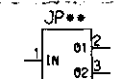

0 OHM REGISTER

1
2
3
4
5

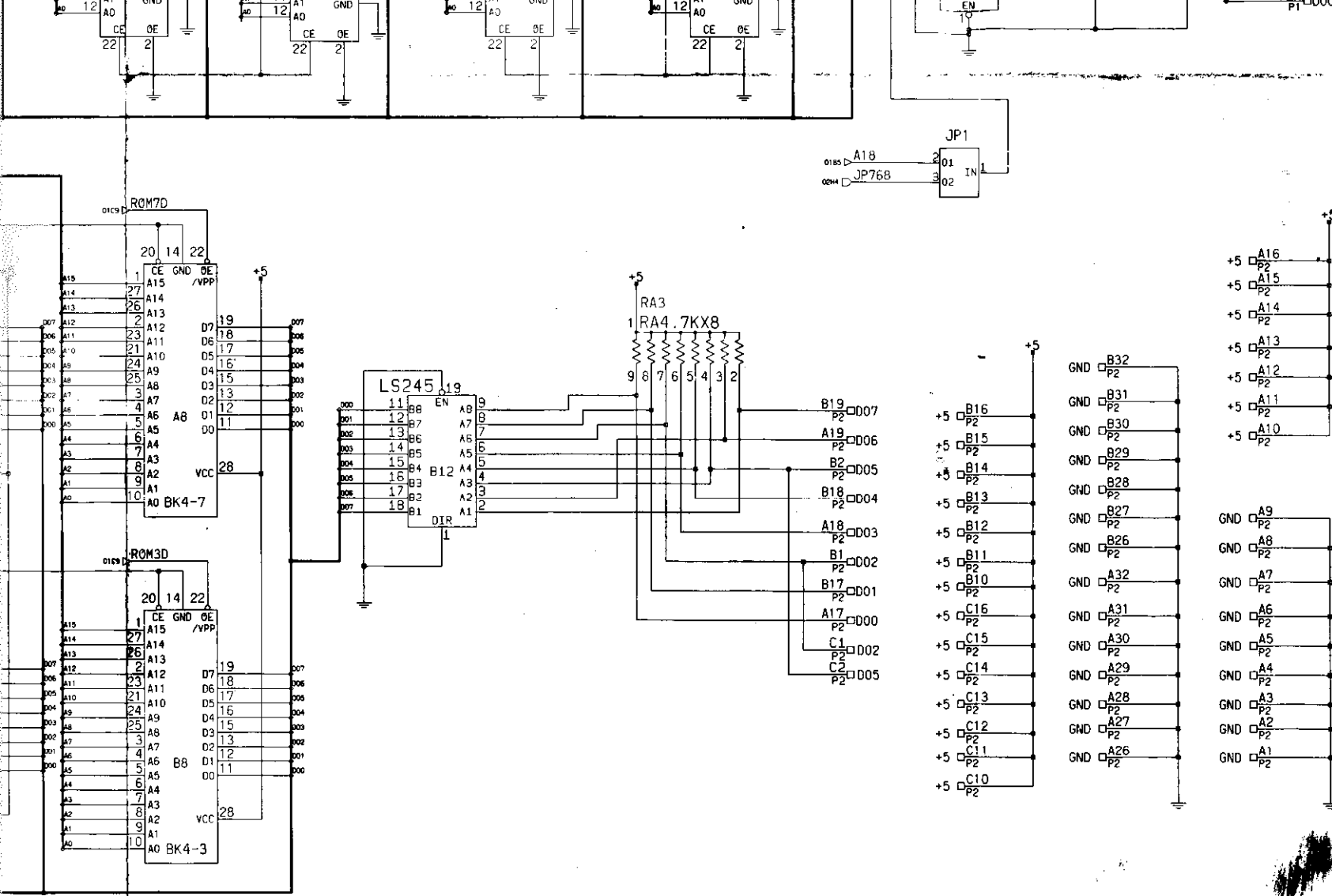

HOW TO USE JUMPER

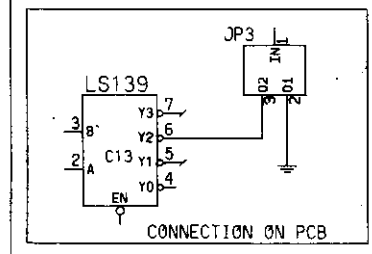
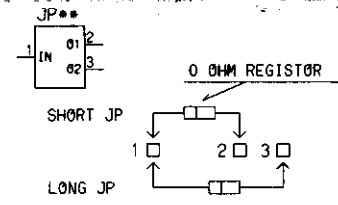

CONNECTION ON PCB

• IF YOU USE THE 16BIT LOAD . THEN YOU MUST TO REPAIR THIS CONNECTION

HOW TO USE P2 (CN2)

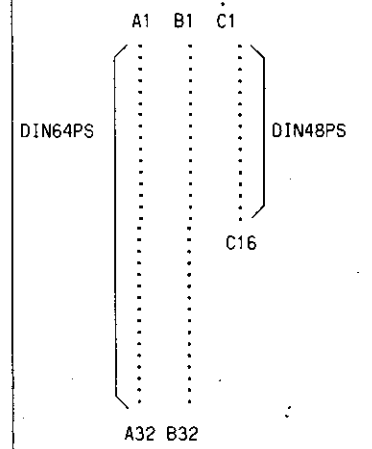

- P1 DIN64PS
- P2 DIN64PS
- P2 DIN48PS
- P3 DIN64PS
- P4 DIN64PS

SUPER CONTRA

				KONAMI INDUSTRY CO.,LTD.				REG. TYPE	SCHMATIC DIAGRAM
DESIGN	DRAW	CHECK	APPROVE	RELEASE DATE		NAME		ROM BOARD 34M PWB350958	
S.	T.			SCALE	1 : 1	TOLE-RANCE	A1	CODE NO. 100087 1/2	
YASUDA	MATSUURA								

G H I J K L

5
6
7
8
9

A B C D E F G

1

2

3

4

5

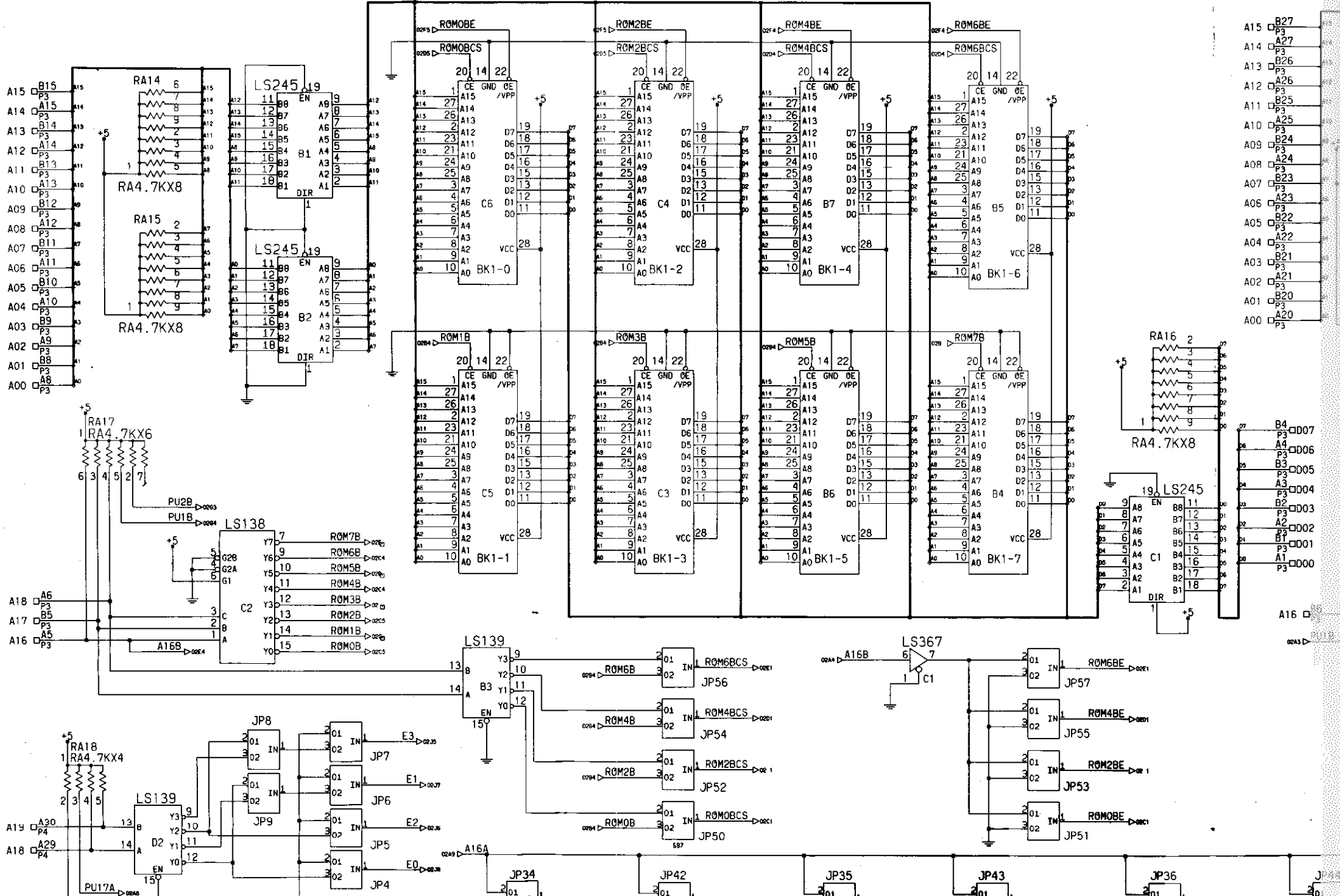

- A15 □ B27
- A14 □ A27
- A13 □ B26
- A12 □ A26
- A11 □ B25
- A10 □ A25
- A09 □ B24
- A08 □ A24
- A07 □ B23
- A06 □ A23
- A05 □ B22
- A04 □ A22
- A03 □ B21
- A02 □ A21
- A01 □ B20
- A00 □ A20

- B4 □ D07
- A4 □ D06
- B3 □ D05
- A3 □ D04
- B2 □ D03
- A2 □ D02
- B1 □ D01
- A1 □ D00

A16 □

02A3 ▷

5

6

7

8

9

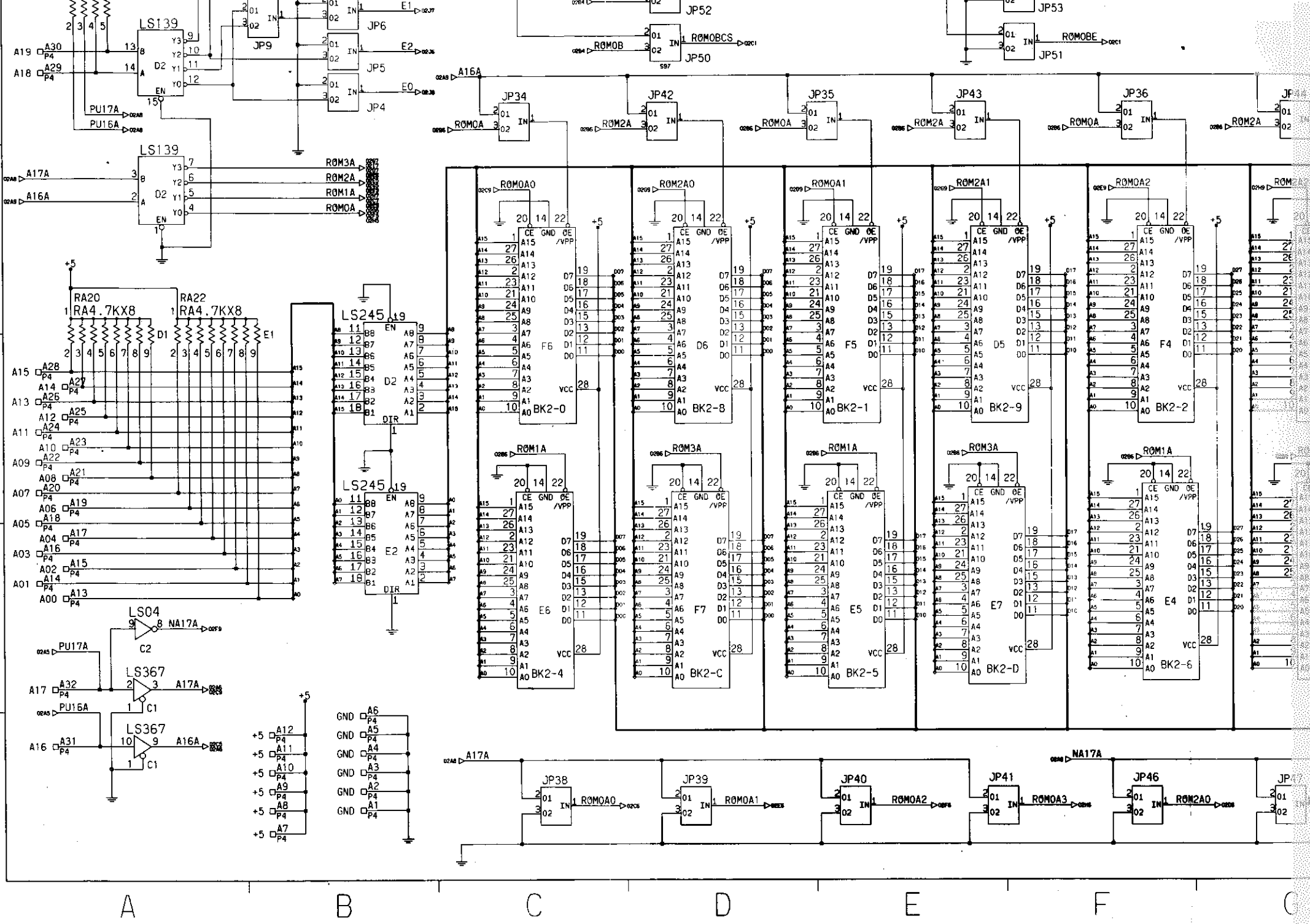

A

B

C

D

E

F

G

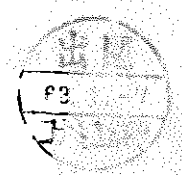
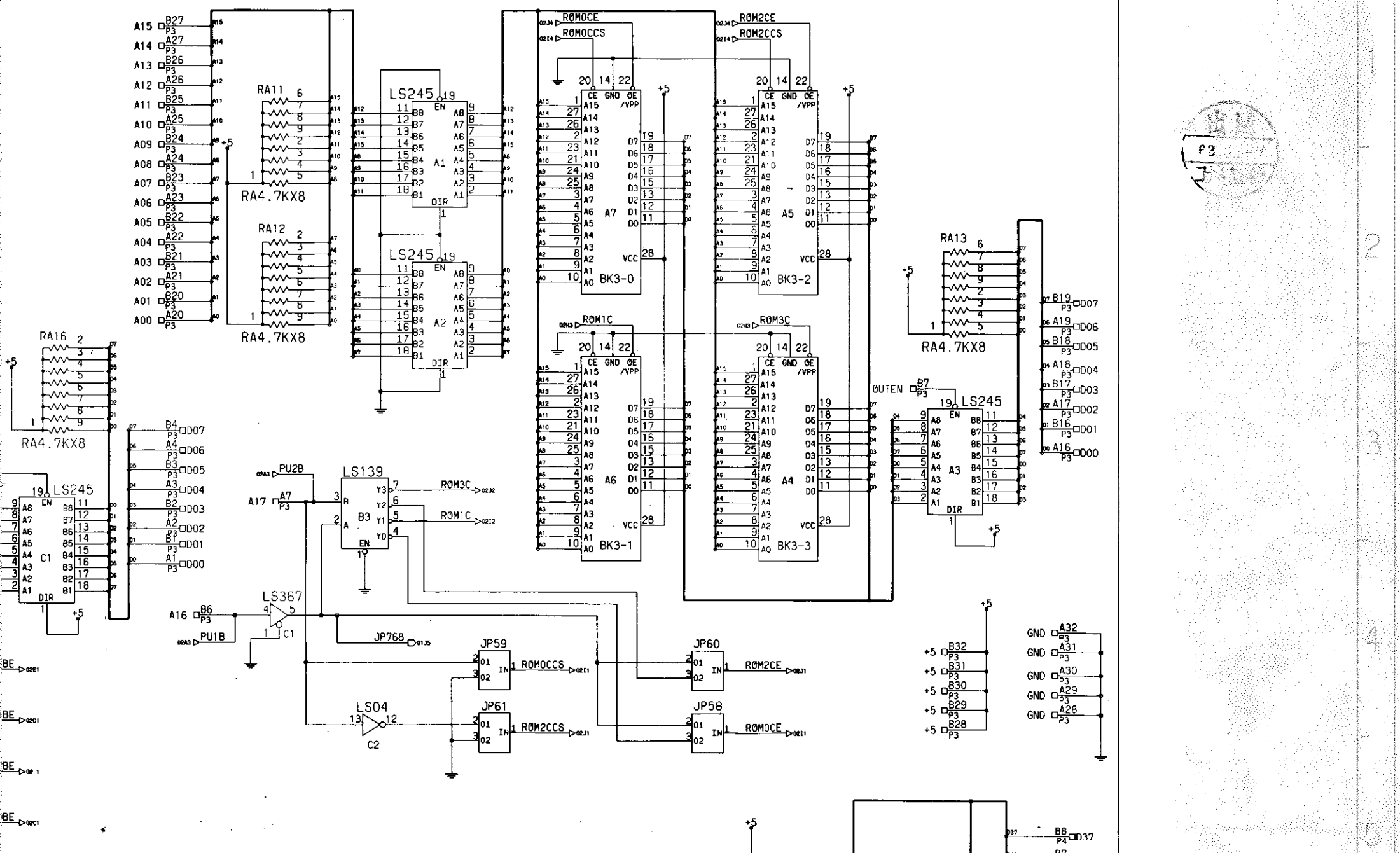

2

3

4

5

BE → 02E1
 BE → 0201
 BE → 02 1
 BE → 02C1

GND A32 P3
 GND A31 P3
 GND A30 P3
 GND A29 P3
 GND A28 P3

+5 B32 P3
 +5 B31 P3
 +5 B30 P3
 +5 B29 P3
 +5 B28 P3

B8 P4 037
 B7 P4 036
 B6 P4 035
 B5 P4

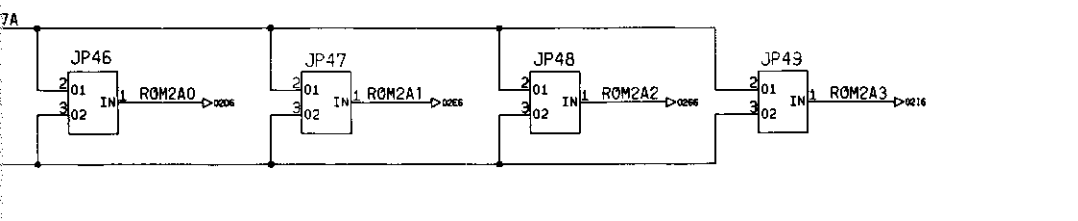
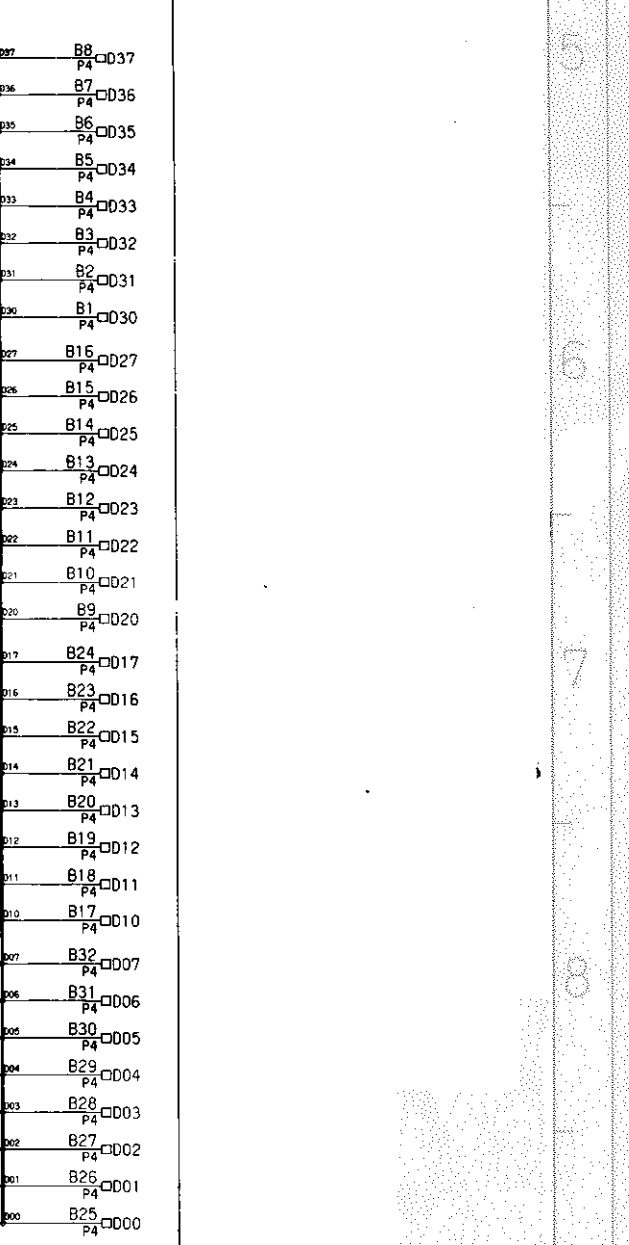
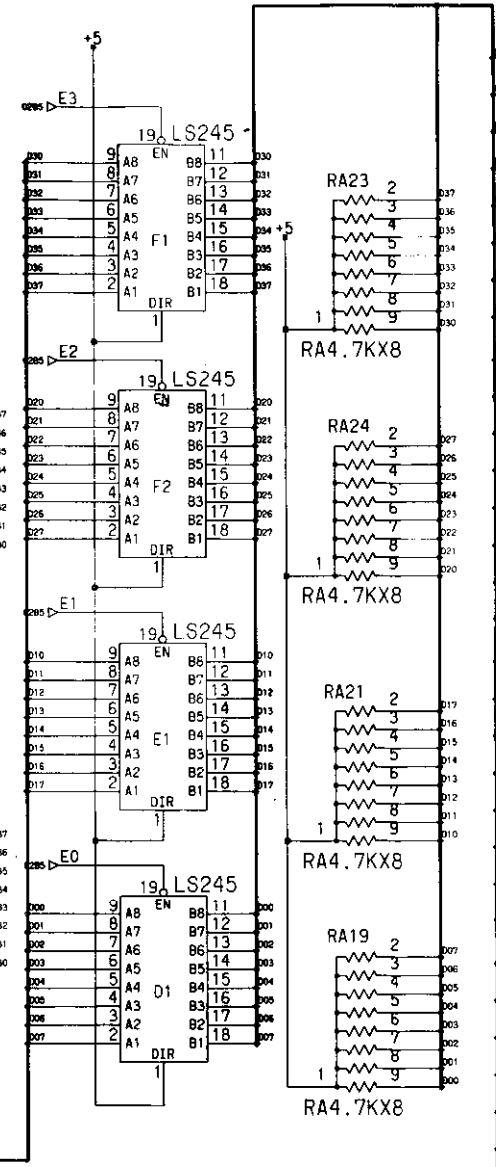
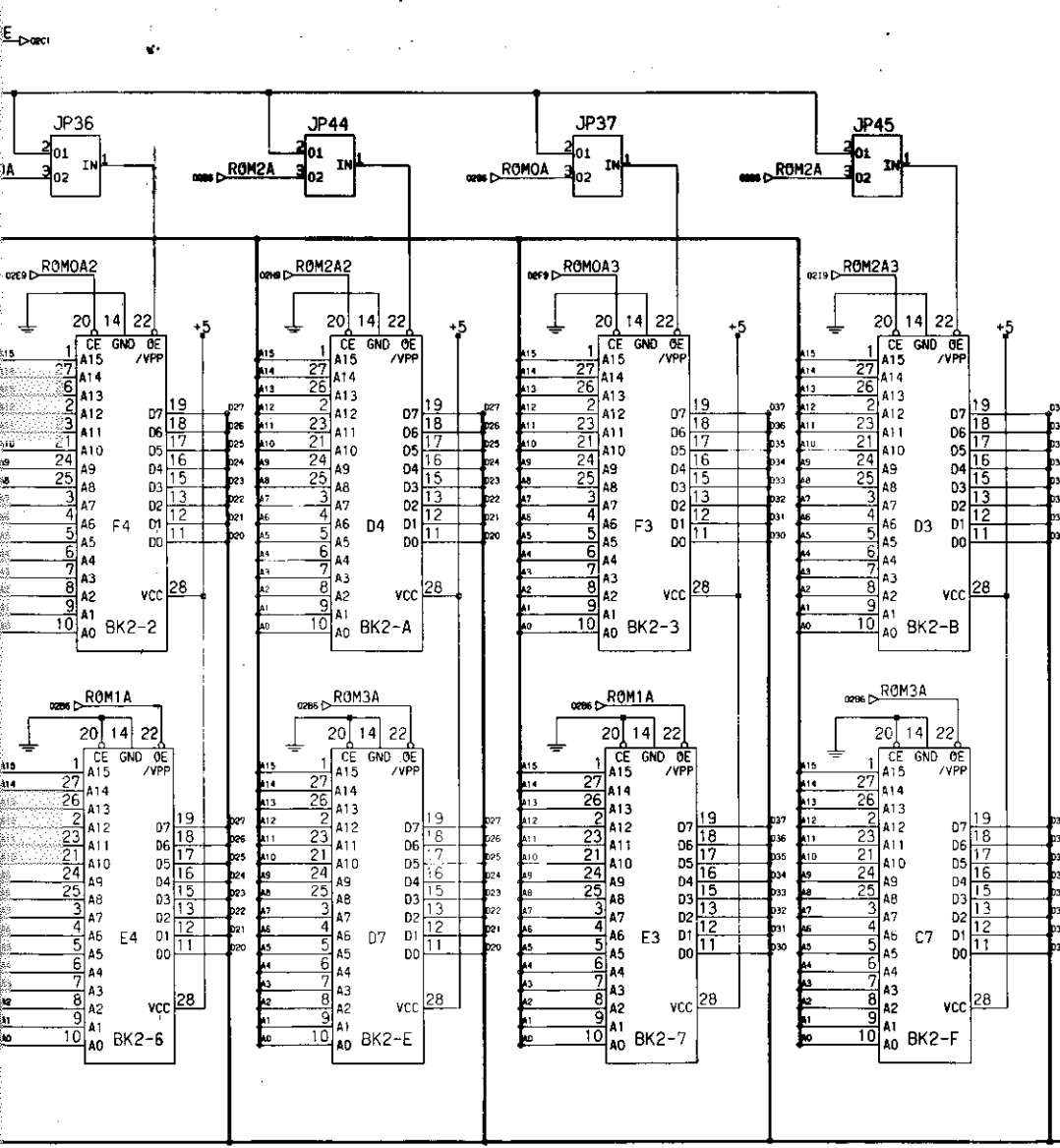

KONAMI				KONAMI INDUSTRY CO., LTD.			REG. TYPE	SCHEMATIC DIAGRAM
DESIGN	DRAW	CHECK	APPROVE	RELEASE DATE		NAME	ROM BOARD JAM PWB350958	
S. YASUDA	T. MATSUURA	<i>H. Matsu</i>	<i>F. Matsu</i>	SCALE	1 : 1	TOLERANCE	A1	
						CODE NO.	100087 2/2	

F G H I J K L